

ER177

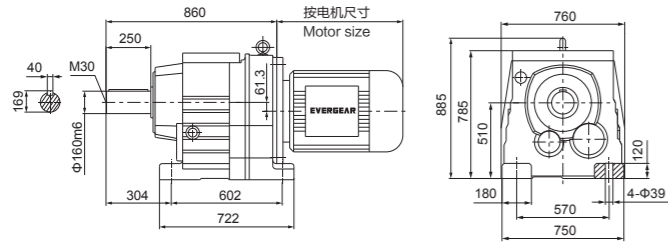

ER..S177

AD5

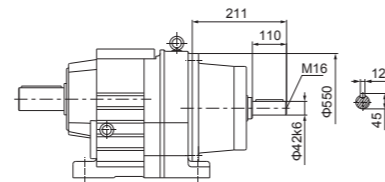

ERF177

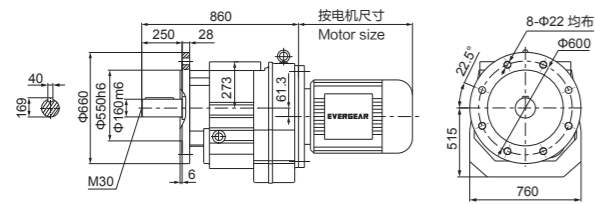

AD6

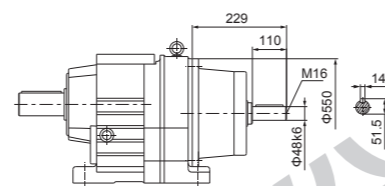

AD7

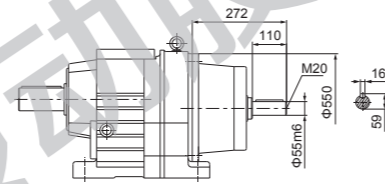

AD8

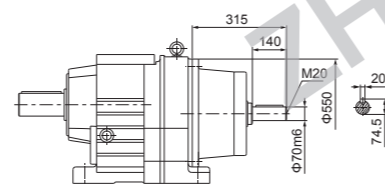

ER..177

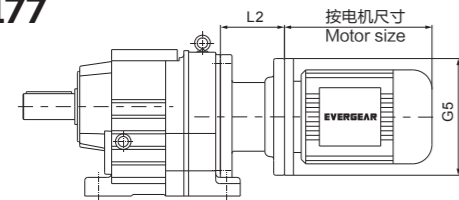

需方自配电机需加联接法兰
Customers provide the motor by themselves need connected flange

Y2电机座号 Motor size	160	180	200	225	250	280	315
功率4P Power/(kw)	11 15	18.5 22	30 37	45 55	75 90	110 132	160 200
L2	107	107	118	156	167	167	171
G5	Φ350	Φ350	Φ400	Φ450	Φ550	Φ550	Φ660

! "ER.."表示ER... ERF.. "ER.." Means ER... ERF..
注 Note

EK Series

斜齿轮-弧齿锥齿轮减速机
Helical - Bevel Gear Motor

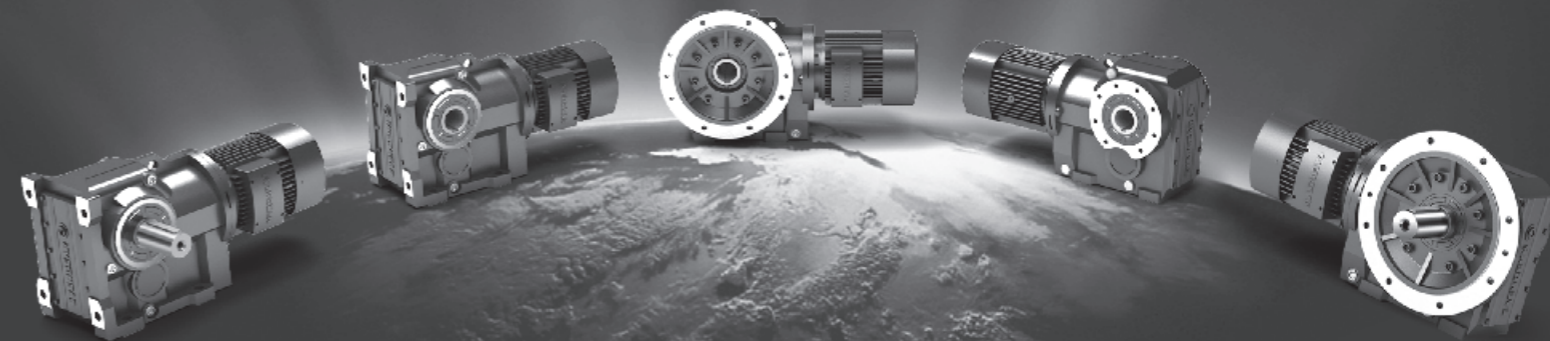

EVERGEAR

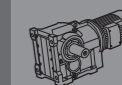
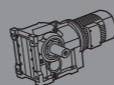

5 结构形式
Mounting type:

EK 底脚安装弧齿锥齿轮硬齿面减速机。 Foot-mounted helical-bevel gear reductor		
EKAB 底脚空心轴安装弧齿锥齿轮硬齿面减速机 Foot-mounted helical-bevel gear reductor with hollow shaft		
EKF B5法兰安装弧齿锥齿轮硬齿面减速机。 Helical-bevel gear reductor in B5 flange-mounted version		
EKAF B5法兰空心轴安装弧齿锥齿轮硬齿面减速机。 Helical-bevel gear reductor in B5 flange-mounted version with hollow shaft		
EKA 空心轴安装弧齿锥齿轮硬齿面减速机。 Helical-bevel gear reductor with hollow shaft		
EKAT 空心轴安装防转臂固定弧齿锥齿轮硬齿面减速机。 Helical-bevel gear reductor in torque-arm version with hollow shaft		
EKAZ B14法兰空心轴安装弧齿锥齿轮硬齿面减速机。 Helical-bevel gear reductor in B14 flange-mounted version with hollow shaft		
EK..ER EK系列与ER..7系列组合减速机。 Combination of EK series reductor and ER..7 series reductor		
EK..S 轴输入型，即配输入轴不配电动机的弧齿锥齿轮硬齿面减速机 Shaft-input style, in another word, helical-bevel gear reductor equipped with input shaft but without the motor		

6 型号说明
Instructions for Models:

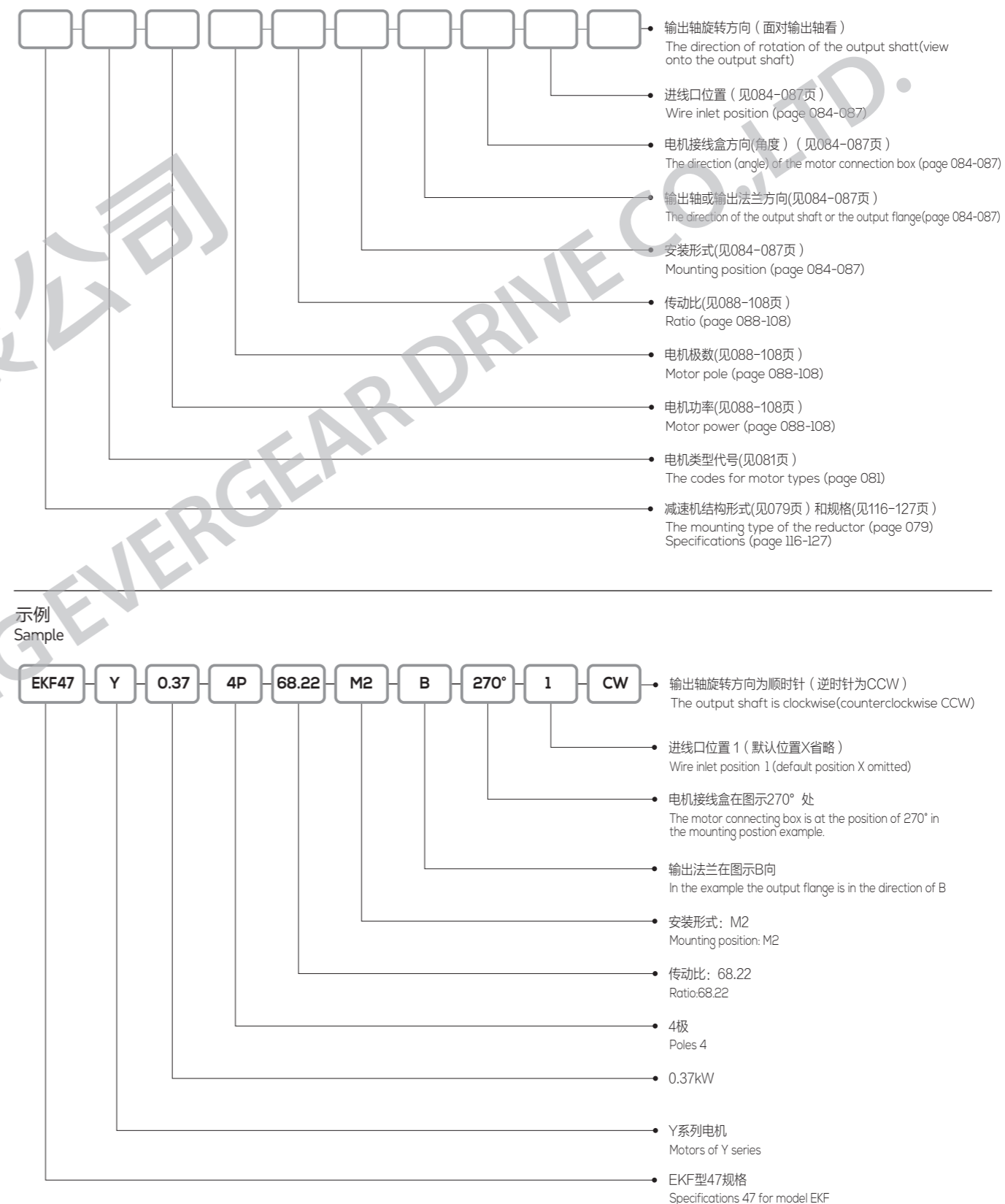

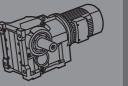
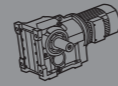

注 Notes

- 1.轴输入型没有电动机的各项内容。
 - 2.无特别说明时Y系列电动机供货按IP54防护等级。
 - 3.不注明安装形式时,按安装形式图(见084-087页)中M1安装形式供货。
 - 4.不注明接线盒角度时,按安装形式图(见084-087页)中0度位置供货。
 - 5.EK、EKF、EKAF、EKAZ型减速机不注明输出轴或输出法兰方向时,按安装形式图(见084-087页)中A向供货。
 - 6.如果减速机只承受单向载荷,请注明从输出轴端方向看的旋转方向,这有利于改善弧齿锥齿轮轴的受力。
1. The shaft-input style is not equipped with any motor
 2. Motors of Y series are supplied with protection grade of IP54 unless otherwise specified.
 3. The mounting position of M1 as shown in the mounting position example (Page 084-087) is the default way when supplying unless otherwise specified.
 4. 0° as shown in the mounting position example (Page 084-087) is the default connection box angle when supplying unless otherwise specified.
 5. The mounting position of A as shown in the mounting position example (Page 084-087) is the default way when supplying reducers such as EK、EKF、EKAF、EKAZ model unless otherwise specified.
 6. It is necessary to note the direction of rotation from the output shaft end.

**电机类型代号
Codes for Motor Types:**

Y	Y系列 Y series	YB	防爆电机 Flameproof Motor	Z	直流电机 Direct Current Motor
YEJ	制动电机 Brake Motor	YG	辊道电机 Roll Motor	YVP	变频电机 Variable Frequency Motor
YVPEJ	变频制动 Transduction braking	YGP	变频辊道 Transduction roller way	YZP	冶金起重 Metallurgy hoisting

**安装形式图释义
Explanation of mounting position example**



**选型参数表释义
Explanation of Parameter Selection List**

输出转速 Output speed	输出转矩 Output torque	传动比 Ratio	使用系数 Service factor	机型号 Type	电机极数 Motor pole
[r/min]	[Nm]	[i]	[fs]		
15kW					
7.9	18100	122.39	1.00		
9.7	14800	100.22	1.20	EK 157	6
11	13500	91.65	1.35	EKA 157	6
12	11800	79.75	1.55	EKF 157	6
14	10400	70.38	1.75	EKAF157	6

1. 选型参数表中的机型可与该栏中的任一传动比搭配。
2. 选型参数表中的参数也适用于EKAB、EKAZ、EKAT、EKH、EKHB、EKHF、EKHT、EKHZ机型。

1. The machine types in the parameter selection list can match any transmission ratio in the column.
2. The parameters in this list also fits model EKAB、EKAZ、EKAT、EKH、EKHB、EKHF、EKHT、EKHZ.

**EK系列输入功率及最大扭矩
Input power and maximum torque of EK series**

型号	Type	EK37	EK47	EK57	EK67	EK77	EK87	EK97	EK107	EK127	EK157	EK167	EK187
结构形式	Structure	EK、EKA、EKH、EKF、EKAF、EKHF、EKAZ、EKHZ、EKAT、EKHT、EKAB、EKHB											
输入功率	Input power rating(kw)	0.12~3	0.12~3	0.12~4	0.18~5.5	0.37~11	0.75~22	1.1~30	3~45	7.5~90	11~200	11~200	18.5~200
传动比	Ratio	3.73~106.93	4.52~119.63	5.00~147.88	5.20~150.15	7.58~210.00	7.21~194.56	7.13~185.35	7.49~149.06	8.68~152.25	12.66~150.41	17.34~164.50	17.18~179.86
最大扭矩*	Maximum torque(Nm)	200	400	600	820	1550	2700	4300	8000	13000	18000	32000	50000

*)最大扭矩指该规格不同传动比对应的最大扭矩的最大值 *The maximum torque indicates the maximum value of maximum torque corresponding to different transmission ratios in this specification

**EK系列主机重量表
Main machine weight form of EK series**

型号	Type	EK37	EK47	EK57	EK67	EK77	EK87	EK97	EK107	EK127	EK157	EK167	EK187
重量	Weight(kg)	19	26	29	33.5	62	103	170	275	437	679	1110	1736
型号	Type	EKF37	EKF47	EKF57	EKF67	EKF77	EKF87	EKF97	EKF107	EKF127	EKF157	EKF167	
重量	Weight(kg)	21	29	33	39.5	70	113	190	286	478	757	1310	
型号	Type	EKA37	EKA47	EKA57	EKA67	EKA77	EKA87	EKA97	EKA107	EKA127	EKA157	EKA167	EKA187
重量	Weight(kg)	19	25	26	31.5	55	91	151	247	409	647	1071	1669
型号	Type	EKAF37	EKAF47	EKAF57	EKAF67	EKAF77	EKAF87	EKAF97	EKAF107	EKAF127	EKAF157	EKAF167	
重量	Weight(kg)	20	28	33	36.5	62	104	175	270	445	703	1271	
型号	Type	EKAT37	EKAT47	EKAT57	EKAT67	EKAT77	EKAT87	EKAT97	EKAT107	EKAT127	EKAT157		
重量	Weight(kg)	21	28	31	36.5	62	103	169	272	469	747		

注:
1)EKAB、EKAZ、EKHB、EKH、EKHZ与EKA主机重量近似。
2)EKHF与EKAF主机重量近似。
3)EKHT与EKAT主机重量近似。

Note:
1)The weight of main machine of EKAB、EKAZ、EKHB、EKH、EKHZ is similar to that of EKA.
2)The weight of main machine of EKHF is similar to that of EKAF.
3)The weight of main machine of EKHT is similar to that of EKAT.

**EK系列润滑油量表
Lubricating oil quantity form of EK series**

型号 Type	润滑油量(升) Fill quantity in liters(L)					
	M1	M2	M3	M4	M5	M6
EK..37	0.5	1	1	1.3	1	1
EK..47	0.8	1.3	1.5	2	1.6	1.6
EK..57	1.2	2.3	2.5	3	2.6	2.4
EK..67	1.1	2.4	2.6	3.4	2.6	2.6
EK..77	2.2	4.1	4.4	5.9	4.2	4.4
EK..87	3.7	8	8.7	10.9	7.8	8
EK..97	7	14	15.7	20	15.7	15.5
EK..107	10	21	25.5	33.5	24	24
EK..127	21	41.5	44	54	40	41
EK..157	31	62	65	90	58	62
EK..167	35	100	100	125	85	85
EK..187	60	170	170	205	130	130

型号 Type	润滑油量(升) Fill quantity in liters(L)					
	M1	M2	M3	M4	M5	M6
EKF37	0.5	1.1	1.1	1.5	1	1
EKF47	0.8	1.3	1.7	2.2	1.6	1.6
EKF57	1.3	2.3	2.7	3	2.9	2.7
EKF67	1.1	2.4	2.8	3.6	2.7	2.7
EKF77	2.1	4.1	4.4	6	4.5	4.5
EKF87	3.7	8.2	9	11.9	8.4	8.4
EKF97	7	14.7	17.3	21.5	15.7	16.5
EKF107	10	22	26	35	25	25
EKF127	21	41.5	46	55	41	41
EKF157	31	66	69	92	62	62
EKF167	35	100	100	125	85	85

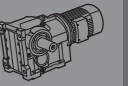
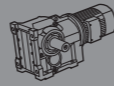

EKA、EKH、EKAF、EKHF、EKAZ、EKHZ、EKAT、EKHT

型号 Type	润滑油量(升) Fill quantity in liters(L)					
	M1	M2	M3	M4	M5	M6
EK..37	0.5	1	1	1.4	1	1
EK..47	0.8	1.3	1.6	2.1	1.6	1.6
EK..57	1.3	2.3	2.7	3	2.9	2.7
EK..67	1.1	2.4	2.7	3.6	2.6	2.6
EK..77	2.1	4.1	4.6	6	4.4	4.4
EK..87	3.7	8.2	8.8	11.1	8	8
EK..97	7	14.7	15.7	20	15.7	15.7
EK..107	10	20.5	24	32	24	24
EK..127	21	41.5	43	52	40	40
EK..157	31	66	67	87	62	62
EK..167	35	100	100	125	85	85
EK..187	60	170	170	205	130	130

EK/EKAB37-157

安装形式图 Mounting position example

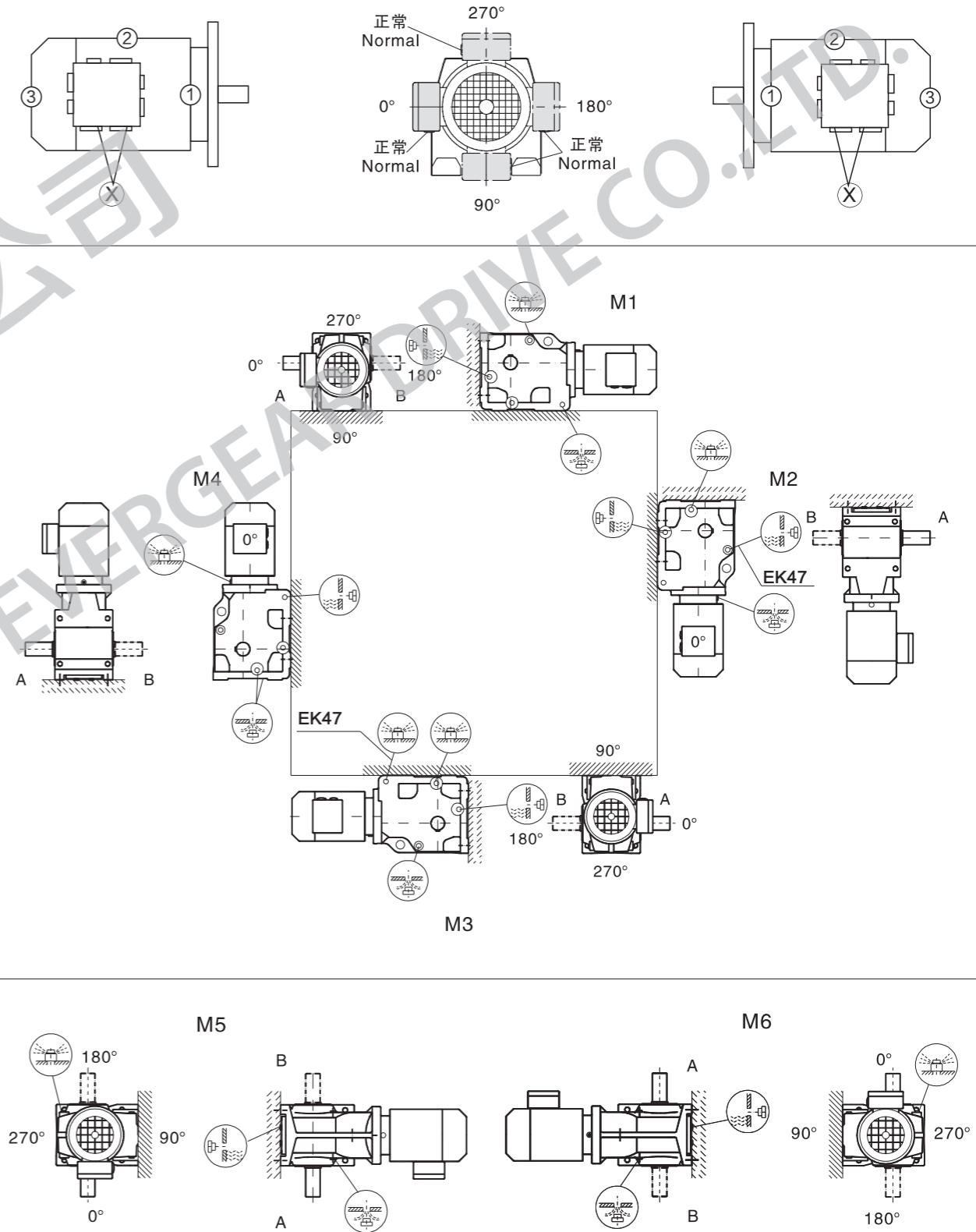

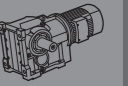
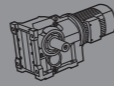

EK/EKA167-187

安装形式图 Mounting position example

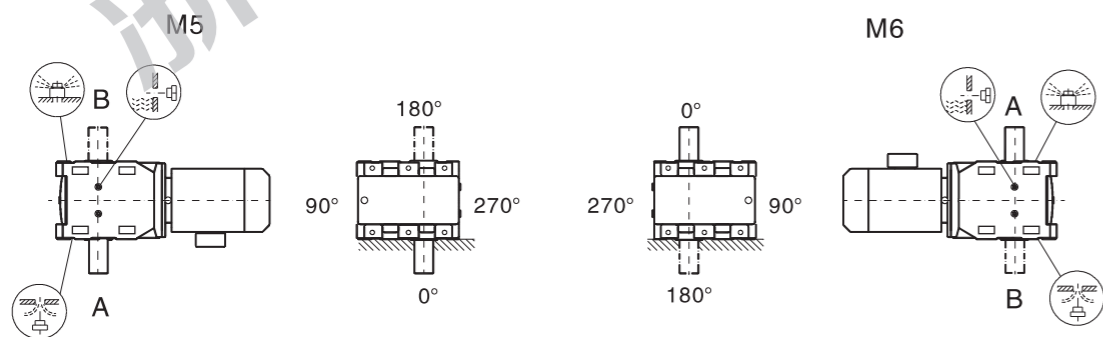
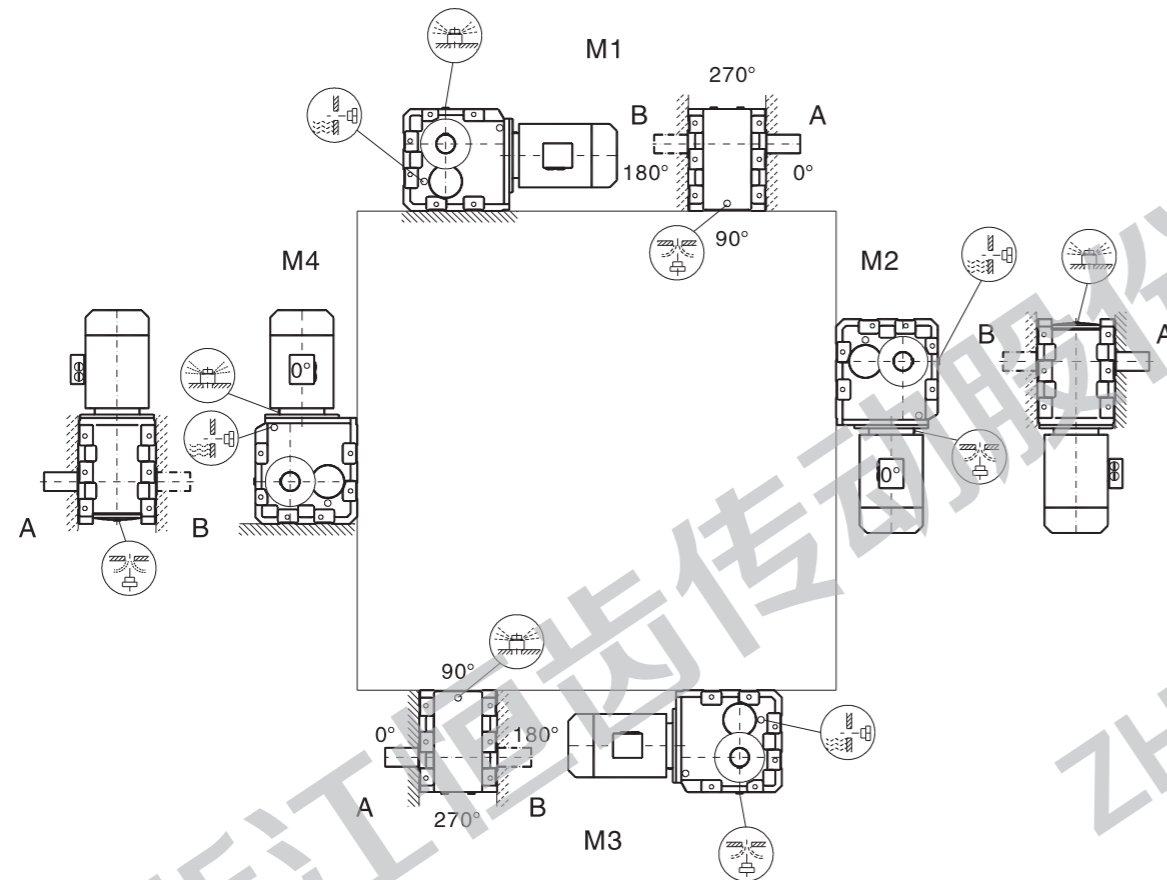
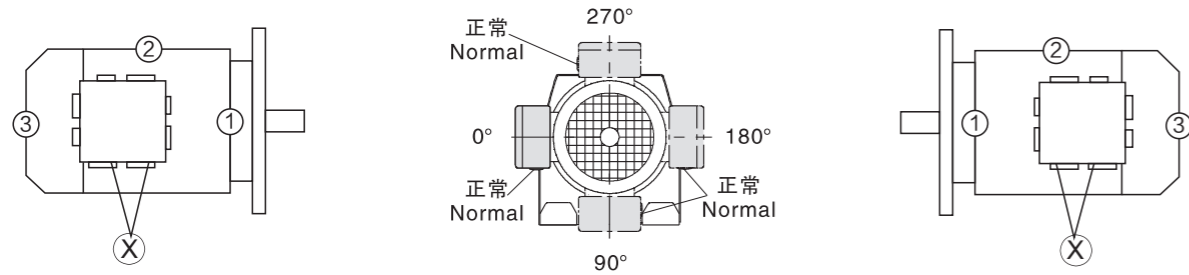

EKA/EKAT37-157

安装形式图 Mounting position example

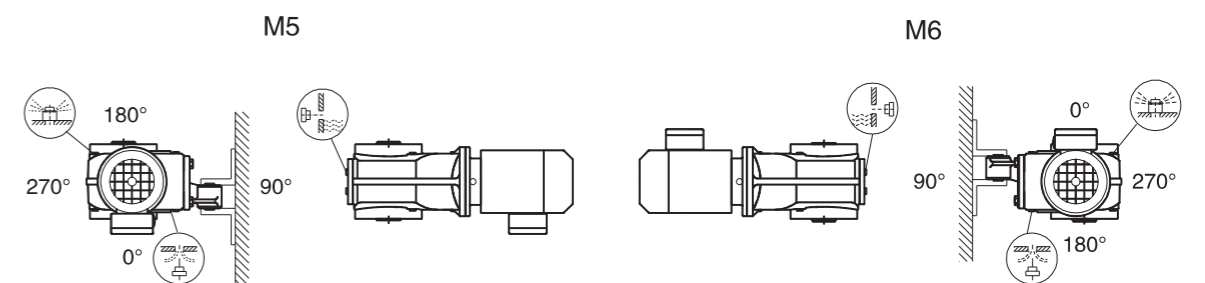
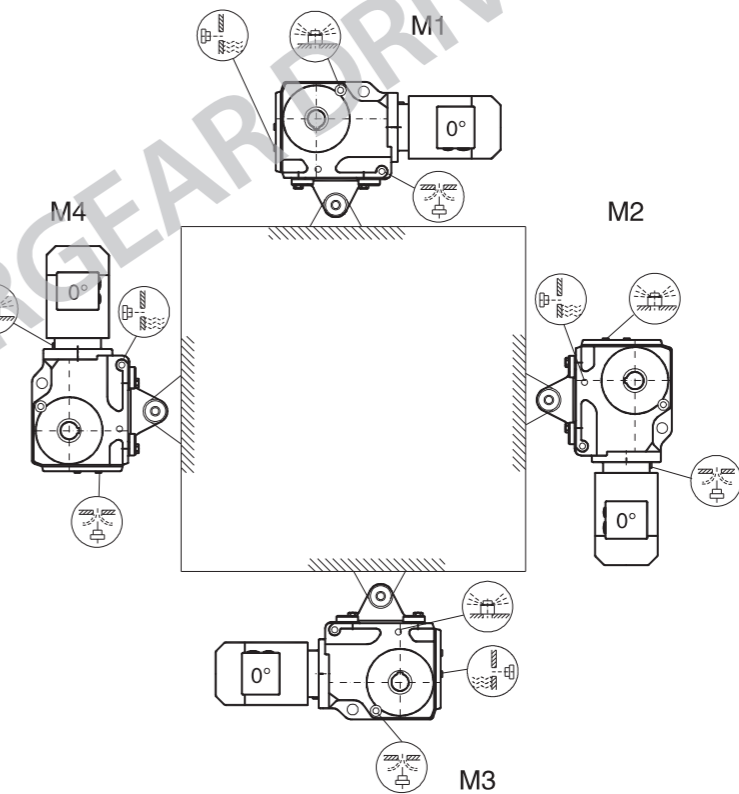
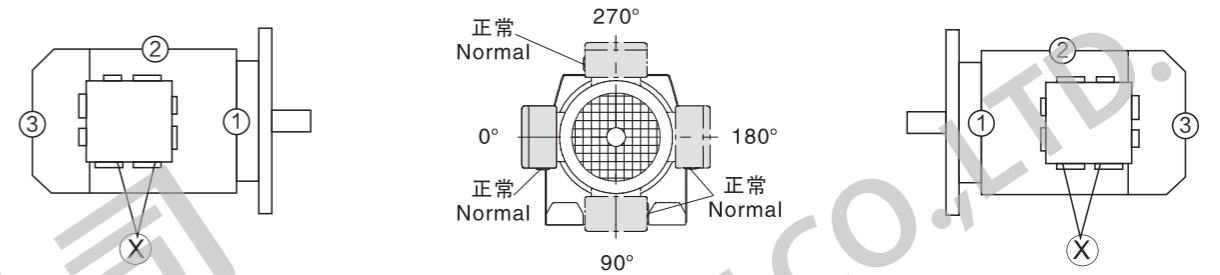

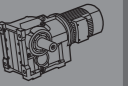
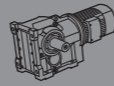

EKF/EKAF/EKAZ37-157

安装形式图 Mounting position example

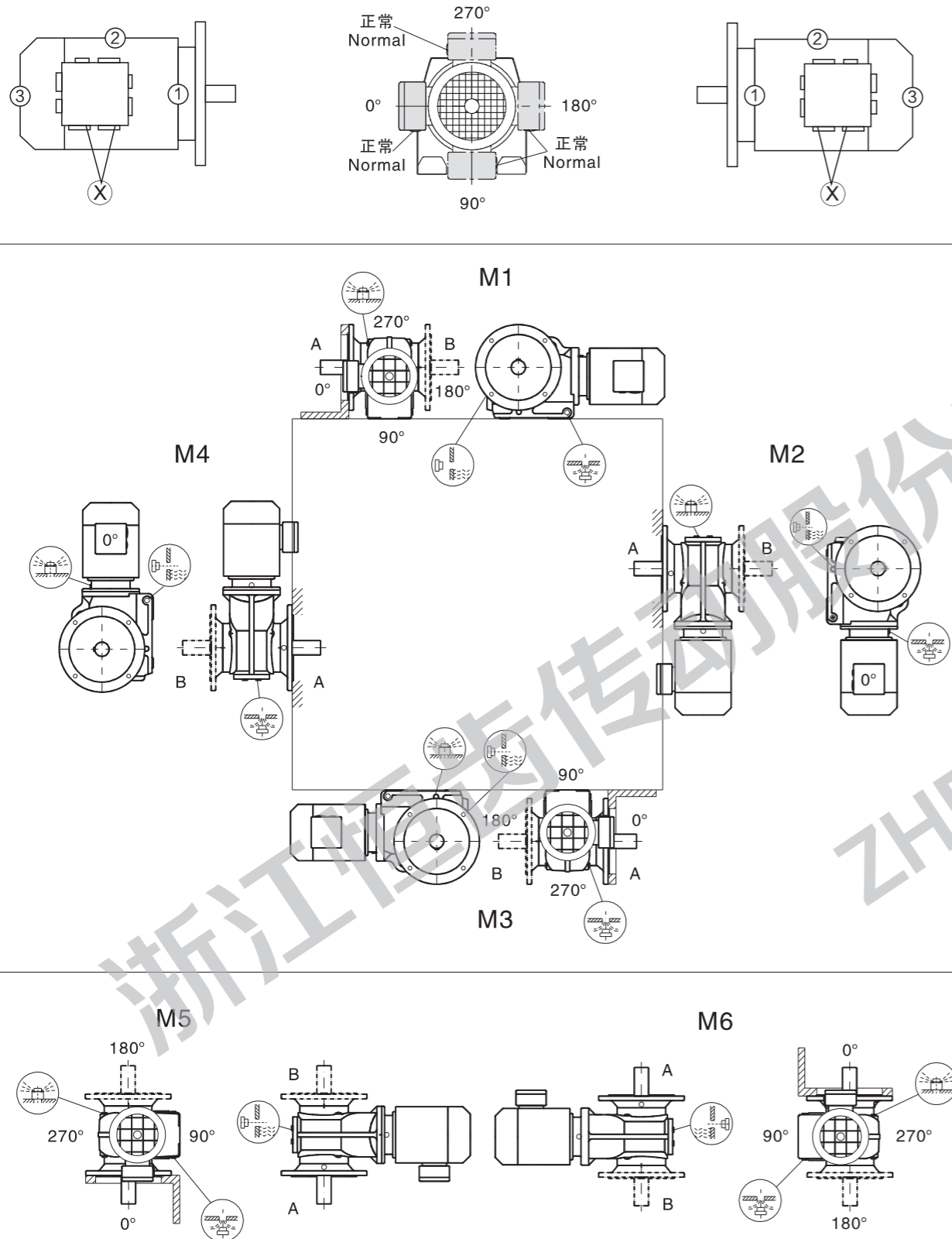

EK系列恒功率选型参数表

Constant power model selection parameter form of EK series

输出转速 Output speed [r/min]	输出转矩 Output torque [Nm]	传动比 Ratio [i]	使用系数 Service factor [f _s]	机型号 Type	电机极数 Motor pole
0.12kW					
0.08	12300	17917	1.05		
0.09	11000	16117	1.20		
0.09	10200	14813	1.30	EK 127ER77	4
0.11	8460	12341	1.55	EKA 127ER77	4
0.13	7440	10858	1.75	EKF 127ER77	4
0.14	6650	9705	1.95	EKAF127ER77	4
0.17	5730	8365	2.3		
0.19	5040	7347	2.6		
0.10	9660	14094	0.85		
0.12	8260	12046	0.95		
0.13	7320	10688	1.10		
0.15	6510	9502	1.25	EK 107ER77	4
0.16	5780	8437	1.40	EKA 107ER77	4
0.19	4990	7277	1.60	EKF 107ER77	4
0.23	4230	6170	1.90	EKAF107ER77	4
0.25	3850	5616	2.1		
0.27	3520	5138	2.3		
0.32	2980	4346	2.7		
0.17	5500	8023	0.80		
0.20	4790	6987	0.90		
0.23	4160	6076	1.05		
0.25	3740	5458	1.15	EK 97ER57	4
0.30	3150	4594	1.35	EKA 97ER57	4
0.34	2800	4079	1.55	EKF 97ER57	4
0.39	2430	3553	1.75	EKAF97ER57	4
0.45	2140	3122	2.0		
0.50	1912	2790	2.2		
0.57	1680	2457	2.6		
0.64	1480	2162	2.9		
0.74	1280	1869	3.4	EK 97ER57	4
0.85	1120	1631	3.8	EKA 97ER57	4
0.98	980	1425	4.4	EKF 97ER57	4
1.1	860	1254	5.0	EKAF97ER57	4
1.3	755	1099	5.7		
0.30	3130	4564	0.85		
0.35	2750	4018	1.00	EK 87ER57	4
0.38	2510	3660	1.10	EKA 87ER57	4
0.44	2150	3131	1.25	EKF 87ER57	4
0.51	1870	2726	1.45	EKAF87ER57	4
0.58	1650	2401	1.65		
0.66	1450	2111	1.85		
0.76	1260	1838	2.1		
0.84	1140	1658	2.4		
0.98	970	1422	2.8	EK 87ER57	4
1.1	840	1232	3.2	EKA 87ER57	4
1.3	730	1066	3.7	EKF 87ER57	4
1.5	650	946	4.2	EKAF87ER57	4
1.7	575	838	4.7		
1.9	495	722	5.5		
2.2	435	633	6.2		
0.52	1840	2689	0.85	EK 77ER37	4
0.59	1610	2350	0.95	EKA 77ER37	4
				EKF 77ER37	4
				EKAF77ER37	4
0.68	1400	2048	1.10		
0.79	1200	1749	1.30		
0.93	1030	1501	1.50		
0.99	960	1399	1.60	EK 77ER37	4
1.1	840	1231	1.85	EKA 77ER37	4
1.3	735	1072	2.1	EKF 77ER37	4
1.5	635	928	2.4	EKAF77ER37	4
1.7	555	808	2.8		
2.0	485	707	3.2		
2.2	430	628	3.6		

输出转速 Output speed [r/min]	输出转矩 Output torque [Nm]	传动比 Ratio [i]	使用系数 Service factor [f _s]	机型号 Type	电机极数 Motor pole
0.12kW					
1.0	910	1326	0.90		
1.2	785	1147	1.05		
1.3	720	1050	1.15		
1.5	625	913	1.30		
1.7	550	801	1.50		
2.0	480	701	1.70		
2.2	425	623	1.90	EK 67ER37	4
2.6	375	544	2.2	EKA 67ER37	4
2.9	325	472	2.5	EKF 67ER37	4
3.3	285	419	2.9	EKAF67ER37	4
3.8	250	362	3.3		
4.3	220	321	3.7		
5.0	191	278	4.3		
5.7	169	246	4.9		
6.3	150	219	5.5		
1.5	625	913	0.95		
1.7	565	821	1.05		
2.0	475	691	1.25		
2.3	420	613	1.45		
2.6	365	536	1.65		
3.0	320	470	1.85	EK 57ER37	4
3.3	285	419	2.1	EKA 57ER37	4
3.9	245	361	2.4	EKF 57ER37	4
4.4	215	316	2.8	EKAF57ER37	4
4.9	193	282	3.1		
5.7	169	246	3.6		
6.5	147	215	4.1		
7.1	134	195	4.5		
2.5	380	553	1.05		
2.8	340	494	1.20	EK 47ER37	4
3.3	290	426	1.35	EKA 47ER37	4
3.7	260	380	1.55	EKF 47ER37	4
4.3	225	325	1.80	EKAF47ER37	4
4.8	199	290	2.0		
4.0	240	347	0.85		
4.5	210	306	0.95		
5.2	182	266	1.10	EK 37ER17	4
5.9	161	235	1.25	EKA 37ER17	4
6.7	141	206	1.40	EKF 37ER17	4
7.6	125	182	1.60	EKAF37ER17	4
8.6	110	161	1.80		
10	93	136	2.1		
9.4	122	147.88	4.9		
11	104	126.18	5.8	EK 57	4
13	91	110.33	6.6	EKA 57	4
13	85	103.59	7.0	EKF 57	4
15	76	91.96	7.9	EKAF57	4
12	99	119.63	4.1	EK 47	4
13	91	110.20	4.4	EKA 47	4
				EKF 47	4
				EKAF47	4
13	88	106.93	2.3		
14	81	98.31	2.5		
17	69	84.12	2.9		
19	60	72.91	3.3		
20	56	68.15	3.6		
24	49	58.91	4.1		
28	41	50.05	4.8		
31	37	44.69	5.4		
36	31	38.17	6.4	EK 37	4
39	29	35.75	6.8	EKA 37	4
46	25	30.12	8.1	EKF 37	4
48	24	28.98	8.4	EKAF37	4
55	21	25.12	9.7		
59	19	23.48	10		
69	17	20.29	11		
81	14	17.24	13		
90	13	15.39	14		
106	11	13.15	15		
122	9.4	11.38	17		

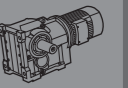
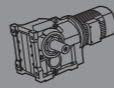
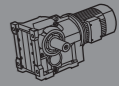
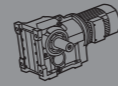

Table with columns: Output speed, Output torque, Ratio, Service factor, Motor pole, and Model. Sub-sections for 0.18kW and 0.25kW power ratings.

Table with columns: Output speed, Output torque, Ratio, Service factor, Motor pole, and Model. Sub-sections for 0.18kW and 0.25kW power ratings.

Table with columns: Output speed, Output torque, Ratio, Service factor, Motor pole, and Model. Sub-sections for 0.18kW and 0.25kW power ratings.

Table with columns: Output speed, Output torque, Ratio, Service factor, Motor pole, and Model. Sub-sections for 0.25kW power ratings.



输出转速 Output speed	输出转矩 Output torque	传动比 Ratio	使用系数 Service factor	机型号 Type	电机极数 Motor pole
[r/min]	[Nm]	(i)	(f _s)		
0.25kW					
5.0	475	128.12	1.75	EK 67	8
5.8	415	112.03	2.0	EKA 67	8
6.1	390	105.19	2.1	EKF 67	8
6.9	345	93.38	2.4	EKAF67	8
5.7	420	150.15	1.95	EK 67	6
6.6	360	128.12	2.3	EKA 67	6
7.6	315	112.03	2.6	EKF 67	6
8.1	295	105.19	2.8	EKAF67	6
9.3	260	150.15	3.2	EK 67	4
11	220	128.12	3.7	EKA 67	4
12	192	112.03	4.3	EKF 67	4
13	181	105.19	4.5	EKAF67	4
5.7	415	147.88	1.45	EK 57	6
6.7	355	126.18	1.70	EKA 57	6
7.7	310	110.33	1.95	EKF 57	6
8.2	290	103.59	2.1	EKAF57	6
9.2	260	91.96	2.3		6
11	220	78.00	2.7		6
9.4	255	147.88	2.4	EK 57	4
11	215	126.18	2.8	EKA 57	4
13	189	110.33	3.2	EKF 57	4
13	178	103.59	3.4	EKAF57	4
15	158	91.96	3.8		4
18	134	78.00	4.5		4
7.1	335	119.63	1.20	EK 47	6
7.7	310	110.20	1.30	EKA 47	6
9.0	265	94.68	1.50	EKF 47	6
10	230	82.42	1.75	EKAF47	6
12	205	119.63	1.95	EK 47	4
13	189	110.20	2.1	EKA 47	4
15	163	94.68	2.5	EKF 47	4
17	142	82.42	2.8	EKAF47	4
10	235	84.12	0.85	EK 37	6
12	205	72.91	1.00	EKA 37	6
12	191	68.15	1.05	EKF 37	6
14	165	58.91	1.20	EKAF37	6
17	141	50.05	1.40		6
13	184	106.93	1.10	EK 87ER57	4
14	169	98.31	1.20	EKA 87ER57	4
17	144	84.12	1.40	EKF 87ER57	4
19	125	72.91	1.60	EKAF87ER57	4
20	117	68.15	1.70		4
24	101	58.91	2.0		4
28	86	50.05	2.3		4
31	77	44.69	2.6		4
36	66	38.17	3.1		4
39	61	35.75	3.3		4
46	52	30.12	3.9	EK 37	4
48	50	28.98	4.0	EKA 37	4
55	43	25.12	4.6	EKF 37	4
59	40	23.48	4.8	EKAF37	4
69	35	20.29	5.3		4
81	30	17.24	6.1		4
90	26	15.39	6.6		4
106	23	13.15	7.3		4
122	20	11.38	8.2		4
141	17	9.83	9.5		4
166	14	8.36	11		4
186	13	7.46	12		4
218	11	6.37	14		4
233	10	5.97	14		4

输出转速 Output speed	输出转矩 Output torque	传动比 Ratio	使用系数 Service factor	机型号 Type	电机极数 Motor pole
[r/min]	[Nm]	(i)	(f _s)		
0.37kW					
0.19	16100	7347	0.80	EK 127ER77	4
0.21	14500	6609	0.90	EKA 127ER77	4
0.24	12700	5814	1.00	EKF 127ER77	4
0.28	11000	5031	1.20	EKAF127ER77	4
0.31	9750	4450	1.35		4
0.36	8530	3893	1.50		4
0.42	7240	3304	1.80		4
0.46	6570	3002	2.0		4
0.53	5720	2613	2.3		4
0.61	5020	2294	2.6		4
0.74	4120	1880	3.2	EK 127ER77	4
0.80	3790	1731	3.4	EKA 127ER77	4
0.92	3320	1515	3.9	EKF 127ER77	4
				EKAF127ER77	4
0.36	8420	3847	0.95	EK 107ER77	4
0.41	7350	3354	1.10	EKA 107ER77	4
0.47	6530	2984	1.20	EKF 107ER77	4
0.53	5750	2625	1.40	EKAF107ER77	4
0.61	5020	2290	1.60		4
0.71	4260	1946	1.90		4
0.82	3710	1693	2.2	EK 107ER77	4
0.91	3340	1525	2.4	EKA 107ER77	4
1.0	2930	1338	2.7	EKF 107ER77	4
1.2	2590	1181	3.1	EKAF107ER77	4
0.64	4730	2162	0.90	EK 97ER57	4
0.74	4090	1869	1.05	EKA 97ER57	4
0.85	3570	1631	1.20	EKF 97ER57	4
0.98	3120	1425	1.40	EKAF97ER57	4
1.1	2750	1254	1.55		4
1.3	2410	1099	1.80		4
1.5	2100	958	2.0		4
1.6	1890	861	2.3		4
1.9	1640	748	2.6		4
2.1	1440	656	3.0		4
2.4	1260	577	3.4		4
0.98	3110	1422	0.85	EK 77ER37	4
1.1	2700	1232	1.00	EKA 77ER37	4
1.3	2330	1066	1.15	EKF 77ER37	4
1.5	2070	946	1.30	EKAF77ER37	4
1.7	1840	838	1.45		4
1.9	1580	722	1.70		4
2.2	1390	633	1.95		4
2.5	1230	562	2.2		4
2.9	1040	474	2.6		4
3.2	940	428	2.9		4
3.7	830	377	3.3		4
1.7	1770	808	0.90	EK 77ER37	4
2.0	1550	707	1.00	EKA 77ER37	4
2.2	1380	628	1.15	EKF 77ER37	4
2.6	1190	545	1.30	EKAF77ER37	4
2.9	1070	487	1.45		4
3.2	940	429	1.65		4
3.8	810	369	1.90		4
4.2	720	329	2.2		4
4.8	640	292	2.4		4
5.6	545	250	2.8		4
6.3	485	221	3.2		4
7.1	430	197	3.6		4
7.9	390	177	4.0		4
8.9	340	156	4.5		4

输出转速 Output speed	输出转矩 Output torque	传动比 Ratio	使用系数 Service factor	机型号 Type	电机极数 Motor pole
[r/min]	[Nm]	(i)	(f _s)		
0.37kW					
3.3	920	419	0.90	EK 67ER37	4
3.8	795	362	1.05	EKA 67ER37	4
4.3	705	321	1.15	EKF 67ER37	4
5.0	610	278	1.35	EKAF67ER37	4
5.7	540	246	1.50		4
6.3	480	219	1.70		4
7.4	415	189	2.0		4
8.4	365	166	2.3		4
9.7	315	143	2.6		4
11	265	122	3.1		4
4.9	620	282	0.95	EK 57ER37	4
5.7	540	246	1.10	EKA 57ER37	4
6.5	470	215	1.25	EKF 57ER37	4
7.1	425	195	1.40	EKAF57ER37	4
8.2	370	169	1.60		4
9.5	320	147	1.85		4
11	285	131	2.1		4
12	245	112	2.4		4
14	210	96	2.9		4
3.9	910	171.71	3.0	EK 87	8
4.1	850	162.00	3.2	EKA 87	8
4.6	765	145.23	3.5	EKF 87	8
				EKAF87	8
4.5	775	194.56	3.5	EK 87	6
5.2	685	171.71	3.9	EKA 87	6
				EKF 87	6
				EKAF87	6
4.5	780	147.83	2.0	EK 77	8
4.8	735	139.13	2.1	EKA 77	8
5.4	655	124.09	2.4	EKF 77	8
6.3	560	106.05	2.8	EKAF77	8
7.0	510	96.25	3.1		8
5.3	670	168.31	2.3	EK 77	6
6.0	590	147.83	2.6	EKA 77	6
6.4	555	139.13	2.8	EKF 77	6
7.1	495	124.09	3.1	EKAF77	6
8.3	425	106.05	3.7		6
6.6	535	210.00	2.7	EK 77	4
7.2	495	194.25	2.9	EKA 77	4
8.3	430	168.31	3.6	EKF 77	4
9.4	375	147.83	4.1	EKAF77	4
6.0	590	112.03	1.40	EK 67	8
6.4	555	105.19	1.50	EKA 67	8
7.2	490	93.38	1.65	EKF 67	8
				EKAF67	8
6.9	510	128.12	1.60	EK 67	6
7.9	445	112.03	1.85	EKA 67	6
8.4	420	105.19	1.95	EKF 67	6
9.5	375	93.38	2.2	EKAF67	6
9.3	380	150.15	2.1	EK 67	4
11	325	128.12	2.5	EKA 67	4
12	285	112.03	2.9	EKF 67	4
13	265	105.19	3.1	EKAF67	4
15	235	93.38	3.5		4
18	200	79.20	4.1		4
19	182	71.50	4.5		4

输出转速 Output speed	输出转矩 Output torque	传动比 Ratio	使用系数 Service factor	机型号 Type	电机极数 Motor pole
[r/min]	[Nm]	(i)	(f _s)		
0.37kW					
7.0	505	126.18	1.20	EK 57	6
8.0	440	110.33	1.35	EKA 57	6
8.5	415	103.59	1.45	EKF 57	6
9.6	365	91.96	1.65	EKAF57	6
11	310	78.00	1.95		6
13	280	70.42	2.1		6
9.4	375	147.88	1.60	EK 57	4
11	320	126.18	1.85	EKA 57	4
13	280	110.33	2.1	EKF 57	4
13	265	103.59	2.3	EKAF57	4
15	235	91.96	2.6		4
18	198	78.00	3.0		4
20	179	70.42	3.4		4
9.3	380	94.68	1.05	EK 47	6
11	330	82.42	1.20	EKA 47	6
11	310	77.21	1.30	EKF 47	6
13	270	68.22	1.45	EKAF47	6
12	305	119.63	1.30	EK 47	4
13	280	110.20	1.45	EKA 47	4
15	240	94.68	1.65	EKF 47	4
17	210	82.42	1.90	EKAF47	4
18	196	77.21	2.0		4
20	173	68.22	2.3		4
22	161	63.36	2.5		4
14	250	98.31	0.80	EK 37	4
17	215	84.12	0.95	EKA 37	4
19	185	72.91	1.10	EKF 37	4
20	1				

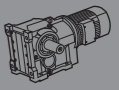
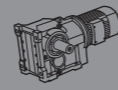
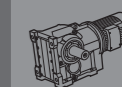
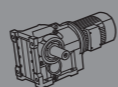

Table with 6 columns: Output speed, Output torque, Ratio, Service factor, Motor type, Motor pole. Data for 0.55kW, 0.74kW, 0.82kW, 0.98kW, 1.5kW, and 2.9kW.

Table with 6 columns: Output speed, Output torque, Ratio, Service factor, Motor type, Motor pole. Data for 0.55kW, 4kW, 6kW, 8kW, 12kW, and 15kW.

Table with 6 columns: Output speed, Output torque, Ratio, Service factor, Motor type, Motor pole. Data for 0.55kW, 0.75kW, and 1.5kW.

Table with 6 columns: Output speed, Output torque, Ratio, Service factor, Motor type, Motor pole. Data for 0.75kW, 1.5kW, 2.2kW, 3.0kW, 4.0kW, and 6.0kW.



输出转速 Output speed [r/min]	输出转矩 Output torque [Nm]	传动比 Ratio (i)	使用系数 Service factor (f _s)	机型号 Type	电机极数 Motor pole
0.75kW					
9.4	760	147.83	2.0		
10	715	139.13	2.2	EK 77	4
11	640	124.09	2.4	EKA 77	4
13	545	106.05	2.8	EKF 77	4
14	495	96.25	3.1	EKAF77	4
12	575	112.03	1.40		
13	540	105.19	1.50		
15	480	93.38	1.70	EK 67	4
18	410	79.20	2.0	EKA 67	4
19	370	71.50	2.2	EKF 67	4
22	325	62.91	2.5	EKAF67	4
23	305	59.40	2.7		
11	650	126.18	0.90		
13	570	110.33	1.05		
13	535	103.59	1.10		
15	475	91.96	1.25	EK 57	4
18	400	78.00	1.50	EKA 57	4
20	365	70.42	1.65	EKF 57	4
22	320	61.95	1.90	EKAF57	4
24	300	58.50	2.0		
28	255	49.81	2.3		
31	235	45.27	2.6		
18	400	77.21	1.00		
20	350	68.22	1.15		
22	325	63.36	1.25		
24	295	57.42	1.35	EK 47	4
27	265	51.56	1.50	EKA 47	4
31	230	44.41	1.75	EKF 47	4
33	215	41.76	1.85	EKAF47	4
39	185	35.93	2.2		
43	165	32.11	2.4		
49	146	28.39	2.7		
31	230	44.69	0.85		
36	197	38.17	1.00		
39	184	35.75	1.10		
46	155	30.12	1.30		
55	129	25.12	1.55		
59	121	23.48	1.60		
69	105	20.29	1.75		
81	89	17.24	2.0	EK 37	4
90	79	15.39	2.2	EKA 37	4
106	68	13.15	2.4	EKF 37	4
122	59	11.38	2.7	EKAF37	4
141	51	9.83	3.2		
166	43	8.36	3.7		
186	38	7.46	4.0		
218	33	6.37	4.6		
233	31	5.97	4.7		
276	26	5.03	5.4		
373	19	3.73	6.5		
1.1kW					
0.15	61300	9409	0.80		
0.17	52200	8011	0.95		
0.19	47800	7327	1.05		
0.21	43900	6734	1.15	EK 187ER97	4
0.23	39000	5980	1.30	EKA187ER97	4
0.26	34800	5346	1.45		
0.29	31300	4807	1.60		
0.32	28400	4361	1.75		

输出转速 Output speed [r/min]	输出转矩 Output torque [Nm]	传动比 Ratio (i)	使用系数 Service factor (f _s)	机型号 Type	电机极数 Motor pole
1.1kW					
0.27	34300	5254	0.95		
0.29	31600	4843	1.00		
0.34	26500	4069	1.20	EK 167ER97	4
0.42	22000	3369	1.45	EKA167ER97	4
0.51	17900	2749	1.80		
0.62	14700	2258	2.2		
0.64	14200	2181	2.3		
0.81	11200	1723	2.8	EK 167ER97	4
1.0	9130	1401	3.5	EKA167ER97	4
1.1	8320	1277	3.8		
0.40	23000	3533	0.80		
0.46	19800	3041	0.90	EK 157ER97	4
0.54	17000	2608	1.05	EKA 157ER97	4
0.60	15200	2335	1.20	EKF 157ER97	4
0.69	13200	2024	1.35	EKAF157ER97	4
0.78	11800	1805	1.55		
0.85	10700	1648	1.70		
1.0	8770	1346	2.1	EK 157ER97	4
1.1	7990	1225	2.3	EKA 157ER97	4
1.3	7150	1097	2.5	EKF 157ER97	4
1.5	6110	938	2.9	EKAF157ER97	4
1.6	5550	851	3.2		
0.74	12300	1880	1.05		
0.81	11300	1731	1.15		
0.92	9880	1515	1.30		
1.0	8900	1365	1.45		
1.2	7810	1198	1.65	EK 127ER77	4
1.3	6790	1041	1.90	EKA 127ER77	4
1.6	5800	889	2.2	EKF 127ER77	4
1.8	5080	780	2.6	EKAF127ER77	4
2.0	4550	698	2.9		
2.3	3980	610	3.3		
2.5	3590	550	3.6		
2.9	3160	484	4.1		
1.2	7700	1181	1.05		
1.3	6830	1047	1.15		
1.6	5860	899	1.35		
1.8	5160	792	1.55		
2.0	4500	691	1.80	EK 107ER77	4
2.2	4090	627	1.95	EKA 107ER77	4
2.7	3380	518	2.4	EKF 107ER77	4
3.1	2970	456	2.7	EKAF107ER77	4
3.5	2640	405	3.0		
3.8	2390	367	3.3		
4.4	2060	316	3.9		
1.9	4880	748	0.90		
2.1	4280	656	1.00		
2.4	3760	577	1.15	EK 97ER57	4
2.8	3290	505	1.30	EKA 97ER57	4
3.2	2850	437	1.50	EKF 97ER57	4
3.6	2530	388	1.70	EKAF97ER57	4
4.1	2240	343	1.90		
3.0	3090	474	0.85		
3.3	2790	428	0.95		
3.7	2460	377	1.10	EK 87ER57	4
4.3	2140	329	1.25	EKA 87ER57	4
4.7	1930	296	1.40	EKF 87ER57	4
5.7	1610	247	1.70	EKAF87ER57	4
5.9	1550	238	1.75		
6.9	1320	202	2.1		

输出转速 Output speed [r/min]	输出转矩 Output torque [Nm]	传动比 Ratio (i)	使用系数 Service factor (f _s)	机型号 Type	电机极数 Motor pole
1.1kW					
3.7	2860	185.35	1.50	EK 97	8
4.2	2490	161.31	1.75	EKA 97	8
4.6	2280	147.69	1.90	EKF 97	8
5.2	2020	130.48	2.1	EKAF97	8
4.9	2140	185.35	2.0	EK 97	6
5.6	1860	161.31	2.3	EKA 97	6
6.2	1700	147.69	2.5	EKF 97	6
7.0	1510	130.48	2.9	EKAF97	6
7.6	1390	185.35	3.1	EK 97	4
8.7	1210	161.31	3.6	EKA 97	4
9.5	1110	147.69	3.9	EKF 97	4
11	980	130.48	4.4	EKAF97	4
5.3	1980	171.71	1.35		
5.6	1870	162.00	1.45	EK 87	6
6.3	1680	145.23	1.60	EKA 87	6
7.3	1440	125.10	1.85	EKF 87	6
8.0	1320	114.17	2.0	EKAF87	6
8.2	1290	171.71	2.1		
8.6	1220	162.00	2.2	EK 87	4
9.6	1090	145.23	2.5	EKA 87	4
11	940	125.10	2.9	EKF 87	4
12	860	114.17	3.2	EKAF87	4
6.5	1610	139.13	0.95	EK 77	6
7.3	1430	124.09	1.10	EKA 77	6
8.6	1220	106.05	1.25	EKF 77	6
9.5	1110	96.25	1.40	EKAF77	6
9.5	1110	147.83	1.40		
10	1040	139.13	1.50		
11	930	124.09	1.65	EK 77	4
13	795	106.05	1.95	EKA 77	4
15	720	96.25	2.1	EKF 77	4
16	640	85.31	2.4	EKAF77	4
17	605	80.85	2.6		
20	530	70.76	2.9		
12	840	112.03	1.00		
13	790	105.19	1.05		
15	700	93.38	1.15		
18	595	79.20	1.40		
20	535	71.50	1.55	EK 67	4
22	470	62.91	1.75	EKA 67	4
24	445	59.40	1.85	EKF 67	4
28	380	50.58	2.2	EKAF67	4
30	345	45.96	2.4		
35	300	39.82	2.7		
38	275	36.93	3.0		
15	690	91.96	0.85		
18	585	78.00	1.05		
20	530	70.42	1.15		
23	465	61.95	1.30		
24	440	58.50	1.35		
28	375	49.81	1.60		
31	340	45.27	1.75		
36	295	39.21	2.0		
38	275	36.37	2.2		
45	230	30.85	2.6		
50	210	27.85	2.9	EK 57	4
57	184	24.50	3.3	EKA 57	4
61	174	23.14	3.5	EKF 57	4
71	148	19.70	3.9	EKAF57	4
78	134	17.90	4.1		
90	116	15.51	4.6		
104	101	13.50	5.0		
110	95	12.72	4.3		
117	90	12.01	4.6		
137	77	10.22	5.3		
151	70	9.29	5.6		
174	60	8.05	6.0		
200	53	7.00	6.6		
280	38	5.00	8.0		

输出转速 Output speed [r/min]	输出转矩 Output torque [Nm]	传动比 Ratio (i)	使用系数 Service factor (f _s)	机型号 Type	电机极数 Motor pole
1.1kW					
24	430	57.42	0.95		
27	385	51.56	1.05		
32	335	44.41	1.20		
34	315	41.76	1.30		
39	270	35.93	1.50	EK 47	4
44	240	32.11	1.65	EKA 47	4
49	215	28.39	1.90	EKF 47	4
53	200	26.60	2.0	EKAF47	4
60	176	23.50	2.3		
64	164	21.83	2.4		
71	148	19.78	2.7		
46	225	30.12	0.90		
56	188	25.12	1.05		
60	176	23.48	1.10		
69	152	20.29	1.20		
81	129	17.24	1.40		
91	115	15.39	1.50		
106	99	13.15	1.65	EK 37	4
123	85	11.38	1.85	EKA 37	4
142	74	9.83	2.2	EKF 37	4
167	63	8.36	2.6	EKAF37	4
188	56	7.46	2.8		
220	48	6.37	3.1		
235	45	5.97	3.2		
278	38	5.03	3.7		
375	28	3.73	4.5		
1.5kW					
0.21	60100	6734	0.85		
0.23	53300	5980	0.95		
0.26	47700	5346	1.05	EK 187ER97	4
0.29	42900	4807	1.15	EKA187ER97	4
0.32	38900	4361	1.30		
0.38	32500	3644	1.55		
0.46	26900	3018	1.85	EK 187ER97	4
0.56	22500	2521	2.2	EKA187ER97	4
0.62	20100	2253	2.5		
0.34	36300	4069	0.90		

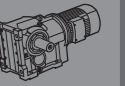
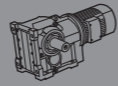

输出转速 Output speed [r/min]	输出转矩 Output torque [Nm]	传动比 Ratio (i)	使用系数 Service factor (f _β)	机型号 Type	电机极数 Motor pole
1.5kW					
0.81	15400	1731	0.85		
0.92	13500	1515	0.95		
1.0	12200	1365	1.05		
1.2	10700	1198	1.20		
1.3	9290	1041	1.40	EK 127ER77	4
1.6	7930	889	1.65	EKA 127ER77	4
1.8	6960	780	1.85	EKF 127ER77	4
2.0	6230	698	2.1	EKAF127ER77	4
2.3	5440	610	2.4		
2.5	4910	550	2.6		
2.9	4320	484	3.0		
3.3	3740	419	3.5		
1.5kW					
8.7	1650	106.05	0.95	EK 77	6
9.6	1500	96.25	1.05	EKA 77	6
11	1330	85.31	1.15	EKF 77	6
11	1260	80.85	1.25	EKAF77	6
1.5kW					
9.5	1510	147.83	1.00		
10	1420	139.13	1.10		
11	1270	124.09	1.20		
13	1090	106.05	1.45		
15	980	96.25	1.55		
16	870	85.31	1.80	EK 77	4
17	830	80.85	1.85	EKA 77	4
20	725	70.76	2.1	EKF 77	4
22	650	63.75	2.4	EKAF77	4
25	570	55.92	2.7		
28	505	49.35	3.1		
32	450	43.75	3.5		
33	430	41.95	3.5		
37	390	38.07	4.0		
1.5kW					
15	960	93.38	0.85		
18	810	79.20	1.00		
20	730	71.50	1.10		
22	645	62.91	1.25		
24	610	59.40	1.35		
28	515	50.58	1.60	EK 67	4
30	470	45.96	1.75	EKA 67	4
35	405	39.82	1.95	EKF 67	4
38	380	36.93	2.2	EKAF67	4
45	320	31.33	2.6		
50	290	28.28	2.8		
56	255	24.88	3.1		
60	240	23.49	3.2		
1.5kW					
23	635	61.95	0.95		
24	600	58.50	1.00		
28	510	49.81	1.20		
31	465	45.27	1.30		
36	400	39.21	1.50	EK 57	4
38	370	36.37	1.60	EKA 57	4
45	315	30.85	1.90	EKF 57	4
50	285	27.85	2.1	EKAF57	4
57	250	24.50	2.4		
61	235	23.14	2.5		
71	200	19.70	2.9		
1.5kW					
34	425	41.76	0.95		
39	370	35.93	1.10		
44	330	32.11	1.20		
49	290	28.39	1.40		
53	270	26.60	1.45		
60	240	23.50	1.65	EK 47	4
64	225	21.83	1.80	EKA 47	4
71	200	19.78	2.0	EKF 47	4
79	182	17.76	2.2	EKAF47	4
92	157	15.30	2.4		
97	147	14.39	2.6		
113	127	12.38	2.8		
122	117	11.48	2.4		
127	113	11.06	3.1		
1.5kW					
60	240	23.48	0.80		
69	210	20.29	0.90		
81	176	17.24	1.00		
91	157	15.39	1.10		
106	135	13.15	1.25		
123	116	11.38	1.35	EK 37	4
142	101	9.83	1.60	EKA 37	4
167	86	8.36	1.85	EKF 37	4
188	76	7.46	2.0	EKAF37	4
220	65	6.37	2.3		
235	61	5.97	2.4		
278	51	5.03	2.7		
375	38	3.73	3.3		

输出转速 Output speed [r/min]	输出转矩 Output torque [Nm]	传动比 Ratio (i)	使用系数 Service factor (f _β)	机型号 Type	电机极数 Motor pole
2.2kW					
0.33	56300	4361	0.90	EK 187ER97	4
0.50	36300	2812	1.40	EKJA187ER97	4
2.2kW					
0.39	47100	3644	1.05		
0.47	39000	3018	1.30		
0.56	32600	2521	1.55		
0.63	29100	2253	1.70	EK 187ER97	4
0.69	26700	2068	1.85	EKA187ER97	4
0.77	23700	1837	2.1		
0.87	21000	1623	2.4		
2.2kW					
0.52	35500	2749	0.90	EK 167ER97	4
0.63	29200	2258	1.10	EKA167ER97	4
2.2kW					
0.65	28200	2181	1.15		
0.82	22300	1723	1.45		
1.0	18100	1401	1.75	EK 167ER97	4
1.1	16500	1277	1.95	EKA167ER97	4
1.3	14100	1092	2.3		
2.2kW					
0.86	21300	1648	0.85		
1.1	17400	1346	1.05		
1.2	15800	1225	1.15	EK 157ER97	4
1.3	14200	1097	1.25	EKA 157ER97	4
1.5	12100	938	1.50	EKF 157ER97	4
1.7	11000	851	1.65	EKAF157ER97	4
2.1	8570	663	2.1		
2.2kW					
2.6	6950	538	1.85		
3.1	6010	465	2.2	EK 127ER87	4
3.5	5310	411	2.4	EK 127ER87	4
3.8	4870	377	2.7	EK 127ER87	4
4.3	4300	333	3.0	EKAF127ER87	4
2.2kW					
1.4	13400	1041	0.95		
1.6	11500	889	1.15		
1.8	10100	780	1.30	EK 127ER77	4
2.0	9020	698	1.45	EKA 127ER77	4
2.3	7880	610	1.65	EKF 127ER77	4
2.6	7110	550	1.85	EKAF127ER77	4
2.9	6250	484	2.1		
3.4	5410	419	2.4		
2.2kW					
2.3	8100	627	1.00		
2.7	6690	518	1.20		
3.1	5890	456	1.35	EK 107ER77	4
3.5	5230	405	1.55	EKA 107ER77	4
3.9	4740	367	1.70	EKF 107ER77	4
4.5	4080	316	1.95	EKAF107ER77	4
5.1	3600	279	2.2		
5.6	3260	252	2.5		
2.2kW					
3.7	5010	388	0.85		
4.1	4430	343	0.95	EK 97ER57	4
4.6	3950	306	1.10	EKA 97ER57	4
5.5	3360	260	1.30	EKF 97ER57	4
6.1	2980	231	1.45	EKAF97ER57	4
7.1	2580	200	1.65		
2.2kW					
4.8	4410	149.06	1.80	EK 107	8
5.6	3730	126.20	2.1	EKA 107	8
6.1	3460	116.79	2.3	EKF 107	8
6.8	3100	104.67	2.6	EKAF107	8
2.2kW					
5.1	4140	185.35	1.05		
5.8	3610	161.31	1.20	EK 97	6
6.4	3300	147.69	1.30	EKA 97	6
7.2	2920	130.48	1.45	EKF 97	6
8.5	2470	110.69	1.75	EKAF97	6

输出转速 Output speed [r/min]	输出转矩 Output torque [Nm]	传动比 Ratio (i)	使用系数 Service factor (f _β)	机型号 Type	电机极数 Motor pole
2.2kW					
7.7	2740	185.35	1.55		
8.8	2390	161.31	1.80		
9.6	2180	147.69	1.95	EK 97	4
11	1930	130.48	2.2	EKA 97	4
13	1640	110.69	2.6	EKF 97	4
14	1510	101.92	2.9	EKAF97	4
16	1350	91.09	3.2		
2.2kW					
9.8	2150	145.23	1.25		
11	1850	125.10	1.45		
12	1690	114.17	1.60	EK 87	4
14	1500	101.25	1.80	EKA 87	4
17	1260	85.11	2.1	EKF 87	4
18	1160	78.21	2.3	EKAF87	4
20	1030	69.46	2.6		
23	920	62.10	2.9		
2.2kW					
11	1840	124.09	0.85		
13	1570	106.05	1.00		
15	1420	96.25	1.10		
17	1260	85.31	1.25		
18	1200	80.85	1.30		
20	1050	70.76	1.50		
22	940	63.75	1.65	EK 77	4
25	830	55.92	1.85	EKA 77	4
29	730	49.35	2.1	EKF 77	4
32	645	43.75	2.4	EKAF77	4
34	620	41.95	2.4		
37	565	38.07	2.8		
42	500	33.74	3.1		
44	475	31.98	3.3		
51	415	27.99	3.7		
56	375	25.22	4.2		
2.2kW					
23	930	62.91	0.90		
24	880	59.40	0.95		
28	750	50.58	1.10		
31	680	45.96	1.20		
36	590	39.82	1.35		
38	545	36.93	1.50		
45	465	31.33	1.75		
50	420	28.28	1.95		
57	370	24.88	2.2	EK 67	4
60	350	23.49	2.2	EKA 67	4
71	295	20.00	2.6	EKF 67	4
78	270	18.18	2.8	EKAF67	4
2.2kW					
90	235	15.75	3.0		
104	205	13.71	3.3		
114	185	12.48	2.9		
134	157	10.63	3.2		
147	143	9.66	3.4		
170	124	8.37	3.6		
195	108	7.28	3.9		
273	77	5.20	4.5		
2.2kW					
31	670	45.27	0.90		
36	580	39.21	1.05		
39	540	36.37	1.10		
46	455	30.85	1.30		
51	410	27.85	1.45		
58	360	24.50	1.65	EK 57	4
61	340	23.14	1.75	EKA 57	4
72	290	19.70	1.95	EKF 57	4
79	265	17.90	2.1	EKAF57	4
92	230	15.51	2.3		
105	200	13.50	2.6		
112	188	12.72	2.2		
118	178	12.01	2.3		
139	151	10.22	2.7		

输出转速 Output speed [r/min]	输出转矩 Output torque [Nm]	传动比 Ratio (i)	使用系数 Service factor (f _β)	机型号 Type	电机极数 Motor pole
2.2kW					
11	1840	124.09	0.85		
13	1570	106.05	1.00		
15	1420	96.25	1.10		
17	1260	85.31	1.25		
18	1200	80.85	1.30		
20	1050	70.76	1.50		
22	940	63.75	1.65	EK 77	4
25	830	55.92	1.85	EKA 77	4
29	730	49.35	2.1	EKF 77	4
32	645	43.75	2.4	EKAF77	4
34	620	41.95	2.4		

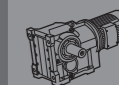
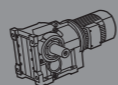
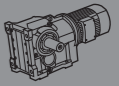
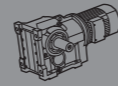

Table with columns: Output speed, Output torque, Ratio, Service factor, Type, Motor pole. Rows are grouped by power: 2.2kW, 3kW, 4kW.

Table with columns: Output speed, Output torque, Ratio, Service factor, Type, Motor pole. Rows are grouped by power: 3kW, 4kW, 5.5kW, 7.5kW.

Table with columns: Output speed, Output torque, Ratio, Service factor, Type, Motor pole. Rows are grouped by power: 3kW, 4kW, 5.5kW, 7.5kW.

Table with columns: Output speed, Output torque, Ratio, Service factor, Type, Motor pole. Rows are grouped by power: 4kW, 5.5kW, 7.5kW, 10kW.



输出转速 Output speed [r/min]	输出转矩 Output torque [Nm]	传动比 Ratio (i)	使用系数 Service factor (f _s)	机型号 Type	电机极数 Motor pole
4kW					
13	3030	114.17	0.90		
14	2690	101.25	1.00		
17	2260	85.11	1.20		
18	2070	78.21	1.30	EK 87	4
21	1840	69.46	1.45	EKA 87	4
23	1650	62.10	1.65	EKF 87	4
26	1480	55.83	1.80	EKAF87	4
30	1290	48.46	2.1		
33	1150	43.39	2.3		
40	950	36.00	2.6		
20	1880	70.76	0.85		
23	1690	63.75	0.90		
26	1480	55.92	1.05		
29	1310	49.35	1.20		
33	1160	43.75	1.35		
34	1110	41.95	1.35	EK 77	4
38	1010	38.07	1.55	EKA 77	4
43	890	33.74	1.75	EKF 77	4
45	850	31.98	1.85	EKAF77	4
51	740	27.99	2.1		
57	670	25.22	2.3		
65	585	22.12	2.6		
74	520	19.52	2.8		
46	830	31.33	1.00		
51	750	28.28	1.10		
58	660	24.88	1.20		
61	625	23.49	1.25		
72	530	20.00	1.45		
79	480	18.18	1.55	EK 67	4
91	420	15.75	1.70	EKA 67	4
105	365	13.71	1.85	EKF 67	4
115	330	12.48	1.60	EKAF67	4
135	280	10.63	1.75		
149	255	9.66	1.85		
172	220	8.37	2.0		
198	193	7.28	2.2		
277	138	5.20	2.5		
59	650	24.50	0.90		
62	615	23.14	1.00		
73	525	19.70	1.10		
80	475	17.90	1.15		
93	410	15.51	1.30		
107	360	13.50	1.40	EK 57	4
113	335	12.72	1.25	EKA 57	4
120	320	12.01	1.30	EKF 57	4
141	270	10.22	1.50	EKAF57	4
155	245	9.29	1.60		
179	215	8.05	1.70		
206	186	7.00	1.85		
288	133	5.00	2.3		
5.5kW					
0.78	58700	1837	0.85		
0.89	51900	1623	0.95		
1.0	44200	1384	1.15		
1.2	38400	1202	1.30	EK 187ER97	4
1.4	33400	1046	1.50	EKA187ER97	4
1.5	30200	945	1.65		
1.9	23600	739	2.1		
2.3	19900	621	2.5		

输出转速 Output speed [r/min]	输出转矩 Output torque [Nm]	传动比 Ratio (i)	使用系数 Service factor (f _s)	机型号 Type	电机极数 Motor pole
5.5kW					
1.3	34900	1092	0.90		
1.5	30000	938	1.05		
1.7	26700	834	1.20		
1.9	23800	746	1.35	EK 167ER97	4
2.3	20200	632	1.60	EKA167ER97	4
2.6	17800	556	1.80		
3.0	15400	481	2.1		
3.4	13500	423	2.4		
2.2	21200	663	0.85		
2.5	18100	567	1.00	EK 157ER97	4
2.9	16100	504	1.10	EKA 157ER97	4
3.3	13900	434	1.30	EKF 157ER97	4
3.8	12100	379	1.50	EKAF157ER97	4
4.3	10800	337	1.65		
3.5	13100	411	1.00		
3.8	12100	377	1.10		
4.3	10600	333	1.20		
4.9	9400	294	1.40	EK 127ER87	4
5.5	8310	260	1.55	EKA 127ER87	4
6.6	7000	219	1.85	EKF 127ER87	4
7.1	6460	202	1.85	EKAF127ER87	4
8.4	5470	171	2.2		
9.5	4830	151	2.5		
6.5	7060	221	1.15		
7.4	6230	195	1.30	EK 107ER77	4
8.3	5530	173	1.30	EKA 107ER77	4
9.0	5110	160	1.40	EKF 107ER77	4
9.9	4640	145	1.55	EKAF107ER77	4
4.8	11000	150.41	1.65	EK 157	8
5.9	8930	122.39	2.0	EKA 157	8
7.2	7310	100.22	2.5	EKF 157	8
7.9	6690	91.65	2.7	EKAF157	8
5.1	10300	141.89	1.25	EK 127	8
5.6	9310	127.66	1.40	EKA 127	8
6.3	8380	114.84	1.55	EKF 127	8
7.7	6830	93.69	1.90	EKAF127	8
6.8	7760	141.89	1.65	EK 127	6
7.5	6980	127.66	1.85	EKA 127	6
8.4	6280	114.84	2.1	EKF 127	6
10	5130	93.69	2.5	EKAF127	6
7.6	6900	126.20	1.15		
8.2	6390	116.79	1.25	EK 107	6
9.2	5730	104.67	1.40	EKA 107	6
10	5170	94.50	1.55	EKF 107	6
11	4700	85.83	1.70	EKAF107	6
9.7	5440	149.06	1.45		
11	4600	126.20	1.75	EK 107	4
12	4260	116.79	1.90	EKA 107	4
14	3820	104.67	2.1	EKF 107	4
15	3450	94.50	2.3	EKAF107	4
17	3130	85.83	2.6		
11	4760	130.48	0.90		
13	4040	110.69	1.05		
14	3720	101.92	1.15		
16	3320	91.09	1.30	EK 97	4
18	2990	82.01	1.45	EKA 97	4
19	2710	74.26	1.60	EKF 97	4
22	2400	65.85	1.80	EKAF97	4
24	2170	59.54	2.0		
29	1840	50.46	2.3		
33	1610	44.08	2.7		

输出转速 Output speed [r/min]	输出转矩 Output torque [Nm]	传动比 Ratio (i)	使用系数 Service factor (f _s)	机型号 Type	电机极数 Motor pole
5.5kW					
17	3100	85.11	0.85		
18	2850	78.21	0.95		
21	2530	69.46	1.05		
23	2260	62.10	1.20	EK 87	4
26	2040	55.83	1.35	EKA 87	4
30	1770	48.46	1.55	EKF 87	4
33	1580	43.39	1.65	EKAF87	4
40	1310	36.00	1.90		
47	1130	30.94	2.4		
52	1000	27.47	2.6		
29	1800	49.35	0.85		
33	1600	43.75	0.95		
43	1230	33.74	1.25		
45	1170	31.98	1.35		
51	1020	27.99	1.50		
57	920	25.22	1.70	EK 77	4
65	810	22.12	1.85	EKA 77	4
74	710	19.52	2.0	EKF 77	4
83	630	17.30	2.2	EKAF77	4
97	540	14.78	2.5		
111	470	12.93	2.1		
127	415	11.34	2.4		
144	365	10.01	2.6		
58	910	24.88	0.90		
61	860	23.49	0.90		
72	730	20.00	1.05		
79	665	18.18	1.10		
91	575	15.75	1.20	EK 67	4
105	500	13.71	1.35	EKA 67	4
115	455	12.48	1.15	EKF 67	4
135	390	10.63	1.30	EKAF67	4
149	350	9.66	1.35		
172	305	8.37	1.45		
198	265	7.28	1.60		
277	190	5.20	1.85		
7.5kW					
1.8	35900	834	1.40		
2.0	31300	728	1.60	EK 187ER107	4
2.4	26700	620	1.85	EKA187ER107	4
1.2	51700	1202	0.95		
1.4	45000	1046	1.10		
1.5	40700	945	1.25	EK 187ER97	4
2.0	31800	739	1.55	EKA187ER97	4
2.4	26700	621	1.85		
2.8	22600	526	2.2		
1.8	35900	834	0.90		
2.0	32100	746	1.00		
2.3	27200	632	1.20		
2.6	23900	556	1.35	EK 167ER97	4
3.0	20700	481	1.55	EKA167ER97	4
3.5	18200	423	1.75		
4.0	15800	368	2.0		
3.4	18700	434	0.95	EK 157ER97	4
3.9	16300	379	1.10	EKA 157ER97	4
4.3	14500	337	1.25	EKF 157ER97	4
5.0	12600	293	1.45	EKAF157ER97	4
4.4	14300	333	0.90		
5.0	12700	294	1.05		
5.6	11200	260	1.15	EK 127ER87	4
6.7	9430	219	1.40	EKA 127ER87	4
7.2	8690	202	1.40	EKF 127ER87	4
8.5	7360	171	1.65	EKAF127ER87	4
9.7	6500	151	1.85		

输出转速 Output speed [r/min]	输出转矩 Output torque [Nm]	传动比 Ratio (i)	使用系数 Service factor (f _s)	机型号 Type	电机极数 Motor pole
7.5kW					
4.4	16400	164.50	1.95	EK 167	8
5.3	13400	134.99	2.4	EKA167	8
5.8	12300	164.50	2.6	EK 167	6
7.1	10100	134.99	3.2	EKA167	6
6.4	11200	150.41	1.60		
7.8	9130	122.39	1.95	EK 157	6
9.6	7480	100.22	2.4	EKA 157	6
10	6840	91.65	2.6	EKF 157	6
12	5950	79.75	3.0		

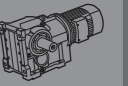
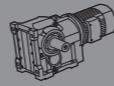

输出转速 Output speed (r/min)	输出转矩 Output torque (Nm)	传动比 Ratio (i)	使用系数 Service factor (f _S)	机型号 Type	电机极数 Motor pole		
11kW							
1.8	52700	834	0.95	EK 187ER107 EKA187ER107	4		
2.0	46000	728	1.10				
2.4	39200	620	1.30				
2.8	32800	519	1.55				
3.2	28600	453	1.75				
4.0	22900	363	2.2				
2.0	46700	739	1.05			EK 187ER97 EKA187ER97	4
2.4	39200	621	1.25				
2.8	33200	526	1.50				
4.6	20000	316	1.60			EK 167ER107 EKA167ER107	4
5.3	17500	277	1.85				
5.9	15500	246	2.1				
7.0	13300	210	2.4				
7.1	12900	205	2.5				
2.6	35100	556	0.90	EK 167ER97 EKA167ER97	4		
3.0	30400	481	1.05				
3.5	26700	423	1.20				
4.0	23200	368	1.40				
4.3	21300	337	0.85	EK 157ER97 EKA 157ER97 EKF 157ER97 EKAF157ER97	4		
5.0	18500	293	0.95				
6.7	13800	219	0.95			EK 127ER87 EKA 127ER87 EK 127ER87 EKAF127ER87	4
7.2	12800	202	0.95				
8.5	10800	171	1.10				
9.7	9540	151	1.25				
5.4	19400	134.99	1.65	EK 167 EKA167	8		
6.6	15800	109.83	2.0				
5.8	18000	164.50	1.80	EK 167 EKA167	6		
7.1	14800	134.99	2.2				
8.9	11800	164.50	2.7	EK 167 EKA167	4		
11	9710	134.99	3.3				
6.0	17600	122.39	1.00	EK 157 EKA 157 EKF 157 EKAF157	8		
7.3	14400	100.22	1.25				
8.0	13200	91.65	1.35				
9.2	11500	79.75	1.55				
6.4	16500	150.41	1.10			EK 157 EKA 157 EKF 157 EKAF157	6
7.8	13400	122.39	1.35				
9.6	11000	100.22	1.65				
10	10000	91.65	1.80				
12	8730	79.75	2.1				
9.7	10800	150.41	1.65	EK 157 EKA 157 EKF 157 EKAF157	4		
12	8810	122.39	2.0				
15	7210	100.22	2.5				
16	6590	91.65	2.7				
10	10200	141.89	1.25	EK 127 EKA 127 EKF 127 EKAF127	4		
11	9180	127.66	1.40				
13	8260	114.84	1.55				
16	6740	93.69	1.95				
17	6150	85.45	2.1				
20	5320	73.95	2.4				
13	8400	116.79	0.95			EK 107 EKA 107 EKF 107 EKAF107	4
14	7530	104.67	1.05				
15	6800	94.50	1.20				
17	6170	85.83	1.30				
19	5480	76.15	1.45				
21	4970	69.11	1.60				
25	4270	59.40	1.85				
28	3730	51.85	2.1				
33	3160	43.98	2.3				
38	2770	38.44	2.6				

输出转速 Output speed (r/min)	输出转矩 Output torque (Nm)	传动比 Ratio (i)	使用系数 Service factor (f _S)	机型号 Type	电机极数 Motor pole		
11kW							
20	5340	74.26	0.80	EK 97 EKA 97 EKF 97 EKAF97	4		
22	4740	65.85	0.90				
25	4280	59.54	1.00				
29	3630	50.46	1.20				
33	3170	44.08	1.35				
36	2900	40.31	1.50				
41	2590	36.03	1.65				
45	2330	32.44	1.85				
50	2110	29.37	2.0				
56	1870	26.05	2.3				
62	1690	23.55	2.5				
34	3120	43.39	0.85			EK 87 EKA 87 EKF 87 EKAF87	4
41	2590	36.00	0.95				
47	2230	30.67	1.20				
53	1980	27.47	1.30				
59	1770	24.56	1.40				
66	1590	22.08	1.45				
76	1380	19.17	1.65				
85	1230	17.16	1.80				
91	1150	16.00	1.55				
103	1020	14.24	2.0				
118	890	12.38	2.2				
131	800	11.16	1.85				
146	720	10.00	2.1				
176	595	8.29	2.3				
202	520	7.21	2.5				
58	1810	25.22	0.85	EK 77 EKA 77 EKF 77 EKAF77	4		
66	1590	22.12	0.95				
75	1400	19.52	1.05				
84	1240	17.30	1.10				
99	1060	14.78	1.25				
113	930	12.98	1.05				
129	820	11.34	1.20				
146	720	10.01	1.30				
165	640	8.87	1.40				
193	545	7.58	1.50				
15kW							
2.4	53400	620	0.95			EK 187ER107 EKA187ER107	4
2.8	44700	519	1.10				
3.2	39000	453	1.30				
4.0	31300	363	1.60				
5.5	23000	267	2.2				
4.6	27200	316	1.15			EK 167ER107 EKA167ER107	4
5.3	23900	277	1.35				
5.9	21200	246	1.50				
7.0	18100	210	1.75				
7.1	17700	205	1.80				
8.3	15100	175	2.1				
9.1	13900	161	2.3				
6.5	19500	226	0.90	EK 157ER107 EKA 157ER107 EKF 157ER107 EKAF157ER107	4		
6.8	18500	215	0.95				
7.8	16000	186	1.10				
9.4	13400	155	1.35				
12	10400	121	1.75				
14	9220	107	1.95				
5.4	26600	179.86	1.90			EK 187 EKA187	6
5.9	24400	165.21	2.0				
7.2	19900	134.99	1.60	EK 167 EKA167	6		
8.8	16200	109.83	1.95				
8.9	16100	164.50	2.0	EK 167 EKA167	4		
11	13200	134.99	2.4				

输出转速 Output speed (r/min)	输出转矩 Output torque (Nm)	传动比 Ratio (i)	使用系数 Service factor (f _S)	机型号 Type	电机极数 Motor pole		
15kW							
7.9	18100	122.39	1.00	EK 157 EKA 157 EKF 157 EKAF157	6		
9.7	14800	100.22	1.20				
11	13500	91.65	1.35				
12	11800	79.75	1.55				
14	10400	70.38	1.75				
9.7	14800	150.41	1.20			EK 157 EKA 157 EKF 157 EKAF157	4
12	12000	122.39	1.50				
15	9830	100.22	1.85				
16	8990	91.65	2.0				
18	7820	79.75	2.3				
10	13900	141.89	0.95	EK 127 EKA 127 EKF 127 EKAF127	4		
11	12500	127.66	1.05				
13	11300	114.84	1.15				
16	9190	93.69	1.40				
17	8380	85.45	1.55				
20	7250	73.95	1.80				
22	6400	65.25	2.0				
26	5530	56.35	2.4				
29	4890	49.84	2.7				
35	4110	41.89	3.2				
15	9270	94.50	0.85			EK 107 EKA 107 EKF 107 EKAF107	4
17	8420	85.83	0.95				
19	7470	76.15	1.05				
21	6780	69.11	1.20				
25	5830	59.40	1.35				
28	5090	51.85	1.55				
33	4310	43.98	1.70				
38	3770	38.44	1.90				
43	3330	33.95	2.2				
45	3190	32.50	2.1				
48	2950	30.12	2.4				
29	4950	50.46	0.85	EK 97 EKA 97 EKF 97 EKAF97	4		
33	4320	44.08	1.00				
36	3950	40.31	1.10				
41	3530	36.03	1.20				
45	3180	32.44	1.35				
50	2880	29.37	1.50				
56	2560	26.05	1.70				
62	2310	23.55	1.85				
73	1960	19.96	2.2				
84	1710	17.43	2.5				
100	1430	14.58	3.0				
47	3040	30.67	0.90	EK 87 EKA 87 EKF 87 EKAF87	4		
53	2690	27.47	0.95				
59	2410	24.56	1.05				
66	2170	22.08	1.05				
76	1880	19.17	1.20				
85	1680	17.16	1.30				
91	1570	16.00	1.15				
103	1400	14.24	1.50				
118	1210	12.38	1.65				
131	1090	11.16	1.35				
146	980	10.00	1.55				
176	810	8.29	1.70				
202	705	7.21	1.85				
18.5kW							
2.8	54800	519	0.90	EK 187ER107 EKA187ER107	4		
3.2	47800	453	1.05				
4.0	38300	363	1.30				
5.5	28200	267	1.75				
6.7	23300	221	2.1				

输出转速 Output speed (r/min)	输出转矩 Output torque (Nm)	传动比 Ratio (i)	使用系数 Service factor (f _S)	机型号 Type	电机极数 Motor pole		
18.5kW							
4.7	33400	316	0.95	EK 167ER107 EKA167ER107	4		
5.3	29200	277	1.10				
6.0	26000	246	1.25				
7.0	22200	210	1.45				
7.2	21600	205	1.50				
8.4	18500	175	1.75				
9.1	17000	161	1.90				
12	12800	121	2.5				
14	11200	106	2.9				
7.9	19600	186	0.90			EK 157ER107 EKA 157ER107 EKF 157ER107 EKAF157ER107	4
9.5	16400	155	1.10				
12	12800	121	1.40				
14	11300	107	1.60				
5.4	32800	179.86	1.55				
5.9	30100	165.21	1.65				
6.7	26300	144.59	1.90				
7.5	23600	129.69	2.1				
8.2	21600	179.86	2.3	EK 187 EKA187	4		
8.9	19900	165.21	2.5				
10	17400	144.59	2.9				
11	15600	129.69	3.2				
11	16200	134.99	1.95	EK 167 EKA167	4		
13	13200	109.83	2.4				
17	10600	87.86	3.0				
9.7	18300	100.22	1.00	EK 157 EKA 157 EKF 157 EKAF157	6		
11	16700	91.65	1.10				
12	14500	79.75	1.25				
14	12800	70.38	1.40				
12	14700	122.39	1.20	EK 157 EKA 157 EKF 157 EKAF157	4		
15	12000	100.22	1.50				
16	11000	91.65	1.65				
18	9580	79.75	1.90				
21	8460	70.38	2.1				
24	7330	61.02	2.5				
27	6520	54.29	2.8				
32	5540	46.06	3.3				
39	4570	38.02	3.9				
13	13800	114.84	0.95			EK 127 EKA 127 EKF 127 EKAF127	4
16	11300	93.69	1.15				
17	10300	85.45	1.25				
20	8890	73.95	1.45				
23	7840	65.25	1.65				
26	6770	56.35	1.90				
29	5990	49.84	2.2				
35	5030	41.89	2.6				
39	4540	37.77	2.9				
45	3930	32.69	3.3				
51	3470	28.84	3.8				
19	9150	76.15	0.85	EK 107 EKA 107 EKF 107 EKAF107	4		
21	8310	69.11	0.95				
25	7140	59.40	1.10				
28	6230	51.85	1.25				
33	5290	43.98	1.40				
38	4620	38.44	1.55				
43	4080	33.95	1.75				
45	3910	32.50	1.75				
49	3620	30.12	2.0				
54	3280	27.33	2.2				
63	2820	23.49	2.6				
72	2460	20.51	2.9				
85	2090	17.39	3.4				
97	1830	15.20	3.8				
33	5300	44.08	0.80	EK 97 EKA 97 E			

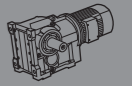
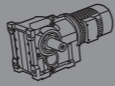

输出转速 Output speed	输出转矩 Output torque	传动比 Ratio	使用系数 Service factor	机型号 Type	电机极数 Motor pole
[r/min]	[Nm]	[i]	[fs]		
18.5kW					
60	2950	24.56	0.85		
67	2650	22.08	0.85		
77	2300	19.17	1.00		
86	2060	17.16	1.05	EK 87	4
103	1710	14.24	1.25	EKA 87	4
119	1490	12.38	1.35	EKF 87	4
132	1340	11.16	1.10	EKAF87	4
147	1200	10.00	1.25		
177	1000	8.29	1.40		
204	870	7.21	1.50		
22kW					
3.2	56900	453	0.90		
4.0	45600	363	1.10		
5.5	33500	267	1.50	EK 187ER107	4
6.7	27800	221	1.80	EKA187ER107	4
7.4	24900	198	2.0		
8.7	21200	169	2.4		
5.3	34800	277	0.90		
6.0	30900	246	1.05		
7.0	26400	210	1.20		
7.2	25700	205	1.25	EK 167ER107	4
8.4	22000	175	1.45	EKA167ER107	4
9.1	20200	161	1.60		
12	15200	121	2.1		
14	13300	106	2.4		
9.5	19500	155	0.90	EK 157ER107	4
12	15200	121	1.20	EKA 157ER107	4
14	13400	107	1.35	EKF 157ER107	4
				EKAF157ER107	4
5.4	39000	179.86	1.30		
5.9	35800	165.21	1.40		
6.7	31300	144.59	1.60	EK 187	6
7.5	28100	129.69	1.80	EKA187	6
8.6	24400	112.60	2.1		
8.2	25700	179.86	1.95		
8.9	23600	165.21	2.1	EK 187	4
10	20700	144.59	2.4	EKA187	4
11	18500	129.69	2.7		
11	19300	134.99	1.65		
13	15700	109.83	2.0	EK 167	4
17	12600	87.86	2.5	EKA167	4
19	11200	78.14	2.9		
9.7	21700	100.22	0.85		
11	19800	91.65	0.90	EK 157	6
12	17300	79.75	1.05	EKA 157	6
14	15200	70.38	1.20	EKF 157	6
16	13200	61.02	1.35	EKAF157	6
12	17500	122.39	1.05		
15	14300	100.22	1.25		
16	13100	91.65	1.35		
18	11400	79.75	1.60	EK 157	4
21	10100	70.38	1.80	EKA 157	4
24	8720	61.02	2.1	EKF 157	4
27	7760	54.29	2.3	EKAF157	4
32	6580	46.06	2.7		
39	5430	38.02	3.3		

输出转速 Output speed	输出转矩 Output torque	传动比 Ratio	使用系数 Service factor	机型号 Type	电机极数 Motor pole
[r/min]	[Nm]	[i]	[fs]		
22kW					
16	13400	93.69	0.95		
17	12200	85.45	1.05		
20	10600	73.95	1.25		
23	9320	65.25	1.40		
26	8050	56.35	1.60	EK 127	4
29	7120	49.84	1.85	EKA 127	4
35	5990	41.89	2.2	EKF 127	4
39	5400	37.77	2.4	EKAF127	4
45	4670	32.69	2.8		
51	4120	28.84	3.2		
59	3560	24.91	3.7		
67	3150	22.03	4.1		
25	8490	59.40	0.95		
28	7410	51.85	1.05		
33	6290	43.98	1.15		
38	5490	38.44	1.30		
43	4850	33.95	1.50		
45	4640	32.50	1.45		
49	4300	30.12	1.65		
54	3910	27.33	1.85	EK 107	4
63	3360	23.49	2.1	EKA 107	4
72	2930	20.51	2.5	EKF 107	4
85	2490	17.39	2.8	EKAF107	4
97	2170	15.20	3.2		
107	1960	13.68	3.7		
123	1710	11.94	4.5		
145	1450	10.13	5.5		
50	4200	29.37	1.00		
56	3720	26.05	1.15		
62	3370	23.55	1.30		
74	2850	19.96	1.50	EK 97	4
84	2490	17.43	1.75	EKA 97	4
101	2080	14.58	2.1	EKF 97	4
116	1800	12.62	2.2	EKAF97	4
130	1610	11.27	1.80		
149	1410	9.84	2.0		
179	1180	8.23	2.3		
77	2740	19.17	0.85		
86	2450	17.16	0.90		
103	2040	14.24	1.05	EK 87	4
119	1770	12.38	1.15	EKA 87	4
132	1590	11.16	0.95	EKF 87	4
147	1430	10.00	1.05	EKAF87	4
177	1180	8.29	1.20		
204	1030	7.21	1.25		
30kW					
5.5	45400	267	1.10		
6.7	37600	221	1.35	EK 187ER107	4
7.5	33700	198	1.50	EKA187ER107	4
8.8	28800	169	1.75		
7.0	35700	210	0.90		
7.2	34900	205	0.90		
8.5	29800	175	1.05	EK 167ER107	4
9.2	27400	161	1.15	EKA167ER107	4
12	20600	121	1.55		
14	18000	106	1.75		
8.2	34800	179.86	1.45		
9.0	32000	165.21	1.55		
10	28000	144.59	1.80		
11	25100	129.69	2.0	EK 187	4
13	21800	112.60	2.3	EKA187	4
14	19800	102.16	2.5		
17	17000	88.00	2.9		

输出转速 Output speed	输出转矩 Output torque	传动比 Ratio	使用系数 Service factor	机型号 Type	电机极数 Motor pole
[r/min]	[Nm]	[i]	[fs]		
30kW					
13	21300	109.83	1.50		
17	17000	87.86	1.90		
19	15100	78.14	2.1	EK 167	4
22	13200	68.07	2.4	EKA167	4
24	11800	60.74	2.7		
15	19400	100.22	0.95		
16	17700	91.65	1.00		
19	15400	79.75	1.15		
21	13600	70.38	1.30	EK 157	4
24	11800	61.02	1.50	EKA 157	4
27	10500	54.29	1.70	EKF 157	4
32	8920	46.06	2.0	EKAF157	4
39	7360	38.02	2.4		
47	6060	31.30	3.0		
20	14300	73.95	0.90		
23	12600	65.25	1.05		
26	10900	56.35	1.20		
30	9650	49.84	1.35	EK 127	4
35	8110	41.89	1.60	EKA 127	4
39	7310	37.77	1.80	EKF 127	4
45	6330	32.69	2.1	EKAF127	4
51	5580	28.84	2.3		
59	4820	24.91	2.7		
67	4260	22.03	3.0		
34	8510	43.98	0.85		
39	7440	38.44	0.95		
46	6290	32.50	1.10		
49	5830	30.12	1.25		
54	5290	27.33	1.35		
63	4550	23.49	1.60	EK 107	4
72	3970	20.51	1.80	EKA 107	4
85	3370	17.39	2.1	EKF 107	4
97	2940	15.20	2.3	EKAF107	4
108	2650	13.68	1.60		
124	2310	11.94	1.85		
146	1960	10.13	2.1		
167	1710	8.85	2.4		
57	5040	26.05	0.85		
63	4560	23.55	0.95		
74	3860	19.96	1.10		
85	3370	17.43	1.25	EK 97	4
102	2820	14.58	1.50	EKA 97	4
117	2440	12.62	1.60	EKF 97	4
131	2180	11.27	1.30	EKAF97	4
150	1900	9.84	1.50		
180	1590	8.23	1.65		
208	1380	7.13	1.95		
37kW					
5.5	56000	267	0.90		
6.7	46400	221	1.10	EK 187ER107	4
7.5	41600	198	1.20	EKA187ER107	4
8.8	35500	169	1.40		
8.5	36700	175	0.85		
9.2	33800	161	0.95	EK 167ER107	4
12	25400	121	1.25	EKA167ER107	4
14	22200	106	1.45		
8.2	42900	179.86	1.15		
9.0	39400	165.21	1.25		
10	34500	144.59	1.45		
11	31000	129.69	1.60	EK 187	4
13	26900	112.60	1.85	EKA187	4
14	24400	102.16	2.1		
17	21000	88.00	2.4		

输出转速 Output speed	输出转矩 Output torque	传动比 Ratio	使用系数 Service factor	机型号 Type	电机极数 Motor pole
[r/min]	[Nm]	[i]	[fs]		
37kW					
13	26200	109.83	1.20		
17	21000	87.86	1.55		
19	18700	78.14	1.70	EK 167	4
22	16300	68.07	1.95	EKA167	4
24	14500	60.74	2.2		
29	12400	51.77	2.6		
16	21900	91.65	0.80		
19	19000	79.75	0.95		
21	16800	70.38	1.05	EK 157	4
24	14600	61.02</			

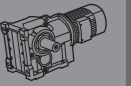
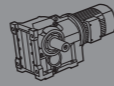

输出转速 Output speed	输出转矩 Output torque	传动比 Ratio	使用系数 Service factor	机型号 Type	电机极数 Motor pole
[r/min]	[Nm]	(i)	(f _β)	Type	Motor pole
45kW					
13	31900	109.83	1.00		
17	25500	87.86	1.25		
19	22700	78.14	1.40		
22	19800	68.07	1.60	EK 167	4
24	17600	60.74	1.80	EKA167	4
29	15000	51.77	2.1		
35	12500	42.89	2.6		
21	20400	70.38	0.90		
24	17700	61.02	1.00		
27	15800	54.29	1.15	EK 157	4
32	13400	46.06	1.35	EKA 157	4
39	11000	38.02	1.65	EKF 157	4
47	9090	31.30	2.0	EKAF157	4
54	8020	27.62	2.2		
62	6950	23.95	2.6		
69	6190	21.31	2.9		
82	5250	18.08	3.4		
30	14500	49.84	0.90		
35	12200	41.89	1.05		
39	11000	37.77	1.20		
45	9490	32.69	1.35	EK 127	4
51	8370	28.84	1.55	EKA 127	4
59	7230	24.91	1.80	EKF 127	4
67	6400	22.03	2.0	EKAF127	4
80	5380	18.52	2.4		
99	4340	14.96	2.8		
116	3710	12.78	2.3		
138	3120	10.74	2.6		
171	2520	8.68	2.9		
49	8750	30.12	0.80		
54	7940	27.33	0.90		
63	6820	23.49	1.05	EK 107	4
72	5950	20.51	1.20	EKA 107	4
85	5050	17.39	1.40	EKF 107	4
97	4410	15.20	1.55	EKAF107	4
108	3970	13.68	1.10		
124	3470	11.94	1.25		
146	2940	10.13	1.40		
167	2570	8.85	1.60		
198	2170	7.49	1.65		
55kW					
10	51300	144.59	0.95		
11	46000	129.69	1.10		
13	40000	112.60	1.25		
14	36300	102.16	1.40	EK 187	4
17	31200	88.00	1.60	EKA187	4
20	26200	73.96	1.90		
23	22700	64.04	2.2		
17	31200	87.86	1.05		
19	27700	78.14	1.15		
22	24200	68.07	1.30	EK 167	4
24	21600	60.74	1.50	EKA167	4
29	18400	51.77	1.75		
35	15200	42.89	2.1		
40	13000	36.61	2.5		

输出转速 Output speed	输出转矩 Output torque	传动比 Ratio	使用系数 Service factor	机型号 Type	电机极数 Motor pole
[r/min]	[Nm]	(i)	(f _β)	Type	Motor pole
55kW					
24	21700	61.02	0.85		
27	19300	54.29	0.95		
32	16300	46.06	1.10		
39	13500	38.02	1.35		
47	11100	31.30	1.60	EK 157	4
54	9800	27.62	1.85	EKA 157	4
62	8500	23.95	2.1	EKF 157	4
69	7560	21.31	2.4	EKAF157	4
82	6420	18.08	2.8		
99	5290	14.92	3.4		
117	4490	12.66	3.8		
35	14900	41.89	0.85		
45	11600	32.69	1.10		
51	10200	28.84	1.25		
59	8840	24.91	1.45	EK 127	4
67	7820	22.03	1.65	EKA 127	4
80	6570	18.52	2.0	EKF 127	4
99	5310	14.96	2.3	EKAF127	4
116	4540	12.78	1.90		
138	3810	10.74	2.1		
171	3080	8.68	2.3		
75kW					
11	62800	129.69	0.80		
13	54500	112.60	0.90		
14	49400	102.16	1.00		
17	42600	88.00	1.15	EK 187	4
20	35800	73.96	1.40	EKA187	4
23	31000	64.04	1.60		
28	25800	53.36	1.95		
33	22000	45.50	2.3		
19	37800	78.14	0.85		
22	32900	68.07	0.95		
24	29400	60.74	1.10		
29	25100	51.77	1.30		
35	20800	42.89	1.55	EK 167	4
40	17700	36.61	1.80	EKA167	4
46	15600	32.25	2.1		
51	13900	28.77	2.3		
60	11900	24.52	2.7		
39	18400	38.02	1.00		
47	15100	31.30	1.20		
54	13400	27.62	1.35	EK 157	4
62	11600	23.95	1.55	EKA 157	4
69	10300	21.31	1.75	EKF 157	4
82	8750	18.08	2.1	EKAF157	4
99	7220	14.92	2.5		
117	6130	12.66	2.8		
45	15800	32.69	0.80		
51	14000	28.84	0.95		
59	12100	24.91	1.10		
67	10700	22.03	1.20	EK 127	4
80	8960	18.52	1.45	EKA 127	4
99	7240	14.96	1.65	EKF 127	4
116	6180	12.78	1.40	EKAF127	4
138	5200	10.74	1.55		
171	4200	8.68	1.70		

输出转速 Output speed	输出转矩 Output torque	传动比 Ratio	使用系数 Service factor	机型号 Type	电机极数 Motor pole
[r/min]	[Nm]	(i)	(f _β)	Type	Motor pole
90kW					
15	59100	102.16	0.85		
17	50900	88.00	1.00		
20	42800	73.96	1.15		
23	37100	64.04	1.35	EK 187	4
28	30900	53.36	1.60	EKA187	4
33	26300	45.50	1.90		
35	24600	42.51	2.0		
39	22300	38.57	2.2		
22	39400	68.07	0.80		
24	35200	60.74	0.90		
29	30000	51.77	1.05		
35	24800	42.89	1.30	EK 167	4
41	21200	36.61	1.50	EKA167	4
46	18700	32.25	1.70		
52	16600	28.77	1.90		
61	14200	24.52	2.3		
73	11800	20.32	2.7		
86	10000	17.34	3.2		
39	22000	38.02	0.80		
47	18100	31.30	1.00		
54	16000	27.62	1.15	EK 157	4
62	13900	23.95	1.30	EKA 157	4
70	12300	21.31	1.45	EKF 157	4
82	10500	18.08	1.70	EKAF157	4
100	8630	14.92	2.1		
117	7330	12.66	2.3		
60	14400	24.91	0.90		
67	12700	22.03	1.00		
80	10700	18.52	1.20	EK 127	4
99	8660	14.96	1.40	EKA 127	4
116	7400	12.78	1.15	EKF 127	4
138	6220	10.74	1.30	EKAF127	4
171	5020	8.68	1.45		
110kW					
17	62200	88.00	0.80		
20	52300	73.96	0.95		
23	45300	64.04	1.10		
28	37700	53.36	1.30		
33	32200	45.50	1.55	EK 187	4
35	30100	42.51	1.65	EKA187	4
39	27300	38.57	1.85		
45	23500	33.23	2.1		
53	19700	27.92	2.5		
29	36600	51.77	0.85		
35	30300	42.89	1.05		
41	25900	36.61	1.25		
46	22800	32.25	1.40	EK 167	4
52	20300	28.77	1.55	EKA167	4
61	17300	24.52	1.85		
73	14400	20.32	2.2		
86	12300	17.34	2.6		
62	16900	23.95	1.05		
70	15100	21.31	1.20	EK 157	4
82	12800	18.08	1.40	EKA 157	4
100	10600	14.92	1.70	EKF 157	4
117	8950	12.66	1.90	EKAF157	4

输出转速 Output speed	输出转矩 Output torque	传动比 Ratio	使用系数 Service factor	机型号 Type	电机极数 Motor pole
[r/min]	[Nm]	(i)	(f _β)	Type	Motor pole
132kW					
20	62800	73.96	0.80		
23	54400	64.04	0.90		
28	45300	53.36	1.10		
33	38600	45.50	1.30		
35	36100	42.51	1.40		
39	32700	38.57	1.55	EK 187	4
45	28200	33.23	1.75	EKA187	4
53	23700	27.92	2.1		
61	20500	24.18	2.3		
74	17100	20.15	2.6		
86	14600	17.18	2.8		
35	36400	42.89	0.90		
41	31100	36.61	1.05		
46	27400	32.25	1.15		
52	24400	28.77	1.30	EK 167	4
61	20800	24.52	1.55	EKA167	4
73	17200	20.32	1.85		
86	14700	17.34	2.2		
62	20300	23.95	0.90		
70	18100	21.31	1.00	EK 157	4
82	15300	18.08	1.15	EKA 157	4
100	12700	14.92	1.10	EKF 157	4
117	10700	12.66	1.60	EKAF157	4
160kW					
28	54900	53.36	0.90		
33	46800	45.50	1.05		
35	43700	42.51	1.15		
39	39700	38.57	1.25		
45	34200	33.23	1.45	EK 187	4
53	28700	27.92	1.75	EKA187	4
61	24900	24.18	1.90		
74	20700	20.15	2.1		
86	17700	17.18	2.3		
41	37700	36.61	0.85		
46	33200	32.25	0.95		
52	29600	28.77	1.10	EK 167	4
61	25200	24.52	1.25	EKA167	4
73	20900	20.32	1.55		
86	17800	17.34	1.80		
82	18600	18.08	0.95	EK 157	4
100	15400	14.92	1.15	EKA 157	4
117	13000	12.66	1.30	EKF 157	4
				EKAF157	4
200kW					
33	58500	45.50	0.85		
35	54700	42.51	0.90		
39	49600	38.57	1.00		
45	42700	33.23	1.15	EK 187	4
53	35900	27.92	1.40	EKA187	4
61	31100	24.18	1.55		
74	25900	20.15	1.70		
86	22100	17.18	1.85		
61	31500	24.52	1.00		
73	26100	20.32	1.20	EK 167	4
86	22300	17.34	1.45	EKA167	4

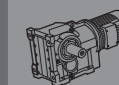
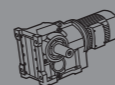

EK系列恒扭矩选型参数表
Constant torque model selection parameter form of EK series

输出转速 Output speed (r/min)	传动比 Ratio (i)	机型号 Type	电机功率 Power (kW)/4P		
200Nm					
0.20	6867	EK 37ER17 EKA 37ER17 EKF 37ER17 EKAF37ER17	0.12		
0.24	5748				
0.25	5638				
0.29	4824				
0.33	4181				
0.38	3664				
0.43	3233				
0.49	2815				
0.56	2467				
0.64	2177				
0.74	1882				
0.83	1668				
0.94	1474				
1.1	1265				
1.2	1142				
1.4	1001			EK 37ER17 EKA 37ER17 EKF 37ER17 EKAF37ER17	0.12
1.6	884				
1.8	764				
2.1	675				
2.4	588				
2.7	512				
3.1	454				
3.5	398				
4.0	347				
4.5	306				
5.2	266		0.18		
5.9	235				
6.7	206				
7.6	182				
8.6	161				
10	136		0.25		
11	128				
13	111				
14	96		0.37		
400Nm					
0.14	10192	EK 47ER37 EKA 47ER37 EKF 47ER37 EKAF47ER37	0.12		
0.16	8542				
0.18	7741				
0.20	6950				
0.23	6045				
0.27	5212				
0.30	4596				
0.35	3963				
0.40	3460				
0.46	3046				
0.51	2717				
0.59	2368				
0.68	2053				
0.76	1820				
0.86	1610				
0.99	1402				
1.1	1223				0.12
1.3	1109				
1.5	930				
1.7	833				
1.9	715				
2.2	640				

输出转速 Output speed (r/min)	传动比 Ratio (i)	机型号 Type	电机功率 Power (kW)/4P		
400Nm					
2.5	553	EK 47ER37 EKA 47ER37 EKF 47ER37 EKAF47ER37	0.18		
2.8	494				
3.3	426				
3.7	380				
4.3	325			0.25	
4.8	290				
5.4	256				
6.2	225			0.37	
7.0	200				
8.2	169				
9.0	155			0.55	
11	131				
600Nm					
0.11	12398	EK 57ER37 EKA 57ER37 EKF 57ER37 EKAF57ER37	0.12		
0.12	11372				
0.15	9335				
0.16	8708				
0.19	7182				
0.22	6375				
0.25	5626				
0.28	4981				
0.32	4308				
0.37	3804				
0.41	3357				
0.47	2976				
0.54	2586				
0.62	2241				
0.69	2007				
0.81	1721				0.12
0.89	1568				
1.0	1373				
1.2	1196				
1.3	1034				
1.5	913				0.18
1.7	821				
2.0	691				
2.3	613				
2.6	536				
3.0	470		0.25		
3.3	419				
3.9	361				
4.4	316		0.37		
4.9	282				
5.7	246				
6.5	215		0.55		
7.1	195				
8.2	169		0.75		
9.5	147				
11	131		1.1		
13	112				
15	96				

输出转速 Output speed (r/min)	传动比 Ratio (i)	机型号 Type	电机功率 Power (kW)/4P		
820Nm					
0.12	11794	EK 67ER37 EKA 67ER37 EKF 67ER37 EKAF67ER37	0.12		
0.13	11074				
0.15	9478				
0.17	8285				
0.19	7292				
0.22	6435				
0.24	5713				
0.29	4845				
0.32	4361				
0.37	3741				
0.41	3369				
0.48	2908				
0.54	2568				
0.61	2275				
0.70	1981				
0.80	1747				0.12
0.91	1529				
1.0	1326				
1.2	1147				0.18
1.3	1050				
1.5	913				
1.7	801				
2.0	701				
2.2	623		0.25		
2.6	544				
2.9	472				
3.3	419		0.37		
3.8	362				
4.3	321				
5.0	278		0.55		
5.7	246				
6.3	219		0.75		
7.4	189				
1550Nm					
0.09	15345	EK 77ER37 EKA 77ER37 EKF 77ER37 EKAF77ER37	0.12		
0.10	14297				
0.12	11771				
0.14	10249				
0.15	8973				
0.18	7539				
0.21	6625				
0.24	5791				
0.27	5109				
0.31	4508				
0.35	3996				
0.40	3436				
0.48	2903				
0.52	2689				
0.59	2350				0.18
0.68	2048				
0.79	1749				
0.93	1501		0.18		
0.99	1399				
1.1	1231		0.25		
1.3	1072				
1.5	928				
1.7	808		0.37		
2.0	707				

输出转速 Output speed (r/min)	传动比 Ratio (i)	机型号 Type	电机功率 Power (kW)/4P		
1550Nm					
2.2	628	EK 77ER37 EKA 77ER37 EKF 77ER37 EKAF77ER37	0.55		
2.6	545				
2.9	487				
3.2	429				
3.8	369				
4.3	329		1.1		
4.8	292				
5.6	250				
6.3	219				
2700Nm					
0.10	14613	EK 87ER57 EKA 87ER57 EKF 87ER57 EKAF87ER57	0.12		
0.11	13041				
0.12	11818				
0.14	10180				
0.15	9092				
0.18	7777				
0.20	6920				
0.24	5877				
0.27	5146				
0.30	4564				
0.35	4018				0.18
0.38	3660				
0.44	3131				
0.51	2726				
0.58	2401				
0.66	2111		0.25		
0.76	1838				
0.84	1658				
0.98	1422		0.37		
1.1	1232				
1.3	1066				
1.5	946		0.55		
1.7	838				
1.9	722				
2.2	633				
2.5	562				
3.0	474		1.1		
3.3	428				
3.7	377				
4.3	329				
4.7	296		1.5		
5.7	247				
6.0	238				
7.0	202		2.2		
7.9	183				
9.0	164				
10.2	145				
11.5	126				
13.0	107				
14.7	90				
16.6	75				
18.8	62				
21.3	51				
24.1	42				
4300Nm					
0.08	17920	EK 97ER57 EKA 97ER57 EKF 97ER57 EKAF97ER57	0.12		
0.08	16644				
0.09	15084				
0.11	13127				
0.12	11716				
0.13	10437				
0.15	9152				
0.17	8023				
0.20	6987				
0.23	6076				0.18
0.25	5458				
0.30	4594				
0.34	4079				
3.9	347				

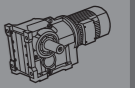
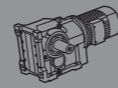

输出转速 Output speed (r/min)	传动比 Ratio (i)	机型号 Type	电机功率 Power (kW)/4P	
4300Nm				
0.39 0.45 0.50	3553 3122 2790	EK 97ER57 EKA 97ER57 EKF 97ER57 EKAF97ER57	0.25	
0.57 0.64	2457 2162		0.37	
0.74 0.85 0.98 1.1	1869 1631 1425 1254		0.55	
1.3 1.5	1099 958		0.75	
1.6 1.9 2.1	861 748 656		1.1	
2.4 2.8	577 505		1.5	
3.2 3.7 4.1	437 388 343		2.2	
4.6 5.5	306 260		3	
6.2 7.2	231 200		4	
8000Nm				
0.10 0.12	14094 12046		EK 107ER77 EKA 107ER77 EKF 107ER77 EKAF107ER77	0.12
0.13 0.15 0.16	10688 9502 8437			0.18
0.19 0.23 0.25	7277 6170 5616			0.25
0.27 0.32 0.36	5138 4346 3847			0.37
0.41 0.47 0.53	3354 2984 2625			0.55
0.61 0.71	2290 1946			0.75
0.83 0.92 1.0	1693 1525 1338			1.1
1.2 1.3 1.6	1181 1047 899			1.5
1.8 2.1 2.3	792 691 627	2.2		
2.7 3.1	518 456	3		
3.6 3.9	405 367	4		
4.6 5.2 5.7	316 279 252	5.5		

输出转速 Output speed (r/min)	传动比 Ratio (i)	机型号 Type	电机功率 Power (kW)/4P	
13000Nm				
0.08 0.09 0.09 0.11	17917 16117 14813 12341	EK 127ER77 EKA 127ER77 EKF 127ER77 EKAF127ER77	0.18	
0.13 0.14 0.17	10858 9705 8365		0.25	
0.19 0.21	7347 6609		0.37	
0.24 0.28 0.31	5814 5031 4450		0.55	
0.36 0.42 0.46	3893 3304 3002		0.75	
0.54 0.61	2613 2294		1.1	
0.74 0.81 0.92	1880 1731 1515		1.5	
1.0 1.2 1.4	1365 1198 1041		2.2	
1.6 1.8	889 780		3	
2.1 2.4 2.6	698 610 550		4	
3.0 3.4	484 419		5.5	
2.7 3.1 3.5	538 465 411		5.5	
3.9 4.4	377 333		7.5	
5.0 5.6	294 260		11	
18000Nm				
0.08 0.09 0.09 0.11 0.12 0.14 0.16 0.18 0.20 0.23	17741 15381 14897 13009 11451 10219 8793 7624 6783 5964		EK 157ER97 EKA 157ER97 EKF 157ER97 EKAF157ER97	0.55
0.28 0.31 0.35 0.40 0.46	5007 4580 3971 3533 3041			1.1
0.54 0.60	2608 2335			1.5

输出转速 Output speed (r/min)	传动比 Ratio (i)	机型号 Type	电机功率 Power (kW)/4P	
18000Nm				
0.70 0.79 0.86 1.1	2024 1805 1648 1346	EK 157ER97 EKA 157ER97 EKF 157ER97 EKAF157ER97	2.2	
1.2 1.3	1225 1097		3	
1.5 1.7	938 851		4	
1.9 2.2 2.5	751 663 567		5.5	
2.9 3.4	504 434		7.5	
3.9 4.3 5.0	379 337 293		11	
3.8 4.5 4.9	384 325 299		11	
5.8 6.5 6.8	251 226 215		15	
32000Nm				
0.07 0.08 0.09 0.11 0.12 0.14	19696 17160 14725 13059 11614 10118		EK 167ER97 EKA167ER97	0.55
0.16	8505			0.75
0.21 0.27	6568 5254			1.1
0.29 0.34	4843 4069			1.5
0.42 0.52	3369 2749			2.2
0.63	2258			3
0.65	2181			3
0.84 1.0	1723 1401			4
1.1 1.3	1277 1092			5.5
1.6 1.8 2.0	938 834 746	7.5		
2.3 2.6	632 556	11		
3.0 3.5 4.0	481 423 368	15		
4.7	316	18.5		
5.3 6.0	277 246	EK 167ER107 EKA167ER107		22

输出转速 Output speed (r/min)	传动比 Ratio (i)	机型号 Type	电机功率 Power (kW)/4P	
32000Nm				
7.0 7.2 8.5	210 205 175	EK 167ER107 EKA167ER107	30	
9.2	161		37	
12	121		45	
50000Nm				
0.04 0.05 0.06 0.07 0.08	33031 26734 24556 18969 16845	EK 187ER97 EKA187ER97	0.55	
0.10 0.11	14068 13181		0.75	
0.12 0.13 0.15 0.17	11753 10417 9409 8011		1.1	
0.19 0.21 0.23	7327 6734 5980		1.5	
0.27 0.30 0.33	5346 4807 4361		2.2	
0.39 0.47	3644 3018		3	
0.57 0.64	2521 2253		4	
0.70 0.78 0.89	2068 1837 1623		5.5	
1.1 1.2	1384 1202		7.5	
1.4 1.5	1046 945		11	
2.0 2.4	739 621		15	
2.8	526		18.5	
1.8	834		EK 187ER107 EKA187ER107	11
2.0 2.4	728 620			15
2.8 3.2	519 453			18.5
4.1	363			30
5.5	267			37
6.7 7.5	221 198			45

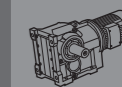
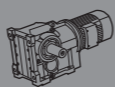

EK系列轴输入型选型参数表 (n=1400 r/min)
Model selection parameter form of shaft input type of EK series(n=1400 r/min)

传动比 Ratio	输出转速 Output speed	许用扭矩 Permissible torque	额定功率 Nominal Power Ratings	机型号 Type	
(i)	[r/min]	[Nm]	[kW]		
106.93	13	200	0.30	AD1	
98.31	14	200	0.32		
84.12	17	200	0.38		
72.91	19	200	0.44		
68.15	21	200	0.47		
58.91	24	200	0.54		
50.05	28	200	0.64		
44.69	31	200	0.71		
38.17	37	200	0.83		
35.75	39	200	0.89		
30.12	46	200	1.1		EK 37 EKA 37 EKF 37 EKAF37
28.98	48	200	1.1		
25.12	56	200	1.3		
23.48	60	195	1.3		
20.29	69	185	1.5		
17.24	81	180	1.7		
15.39	91	175	1.8		
13.15	106	165	2.0		
11.38	123	160	2.2	AD2	
9.83	142	160	2.6		
8.36	168	160	3.1		
7.46	188	155	3.3		
6.37	220	150	3.8		
5.97	235	145	3.9		
5.03	278	140	4.4		
3.73	375	125	5.3		
119.63	12	400	0.53	EK 47 EKA 47 EKF 47 EKAF47	
110.20	13	400	0.58		
94.68	15	400	0.67		
82.42	17	400	0.77		
77.21	18	400	0.83		
68.22	21	400	0.93		
63.36	22	400	1.0		
57.42	24	400	1.1		AD2
51.56	27	400	1.2		
44.41	32	400	1.4		
41.76	34	400	1.5		
35.93	39	400	1.8		
32.11	44	400	2.0		
28.39	49	400	2.2		
26.60	53	400	2.4		
23.50	60	400	2.7		
21.83	64	400	2.9		
19.78	71	400	3.2		
17.76	79	400	3.6		AD3
15.30	92	380	4.0		
14.39	97	380	4.2		
12.38	113	360	4.6		
11.48	122	280	3.9		
11.06	127	350	5.0		
10.30	136	280	4.3		
8.87	158	280	5.0		
8.35	168	270	5.2	AD3	
7.18	195	250	5.5		
6.42	218	240	6.0		
5.48	255	230	6.7		
4.52	310	205	7.2		
147.88	9.5	600	0.65		EK 57 EKA 57 EKF 57 EKAF57
126.18	11	600	0.76		
110.33	13	600	0.87		
103.59	14	600	0.92		
91.96	15	600	1.0		
78.00	18	600	1.2		
70.42	20	600	1.4		
61.95	23	600	1.5		
58.50	24	600	1.6		
43.75	32	1550	5.6	AD3	
41.95	33	1490	5.7		
38.07	37	1410	5.9		

传动比 Ratio	输出转速 Output speed	许用扭矩 Permissible torque	额定功率 Nominal Power Ratings	机型号 Type
(i)	[r/min]	[Nm]	[kW]	
49.81	28	600	1.9	AD2
45.27	31	600	2.1	
39.21	36	600	2.4	
36.37	38	600	2.6	
30.85	45	600	3.1	
27.85	50	600	3.4	
24.50	57	600	3.9	
23.14	61	600	4.1	
19.70	71	575	4.7	
17.90	78	555	4.9	
15.51	90	535	5.5	
13.50	104	510	6.0	
12.72	110	415	5.2	
12.01	117	415	5.5	
10.22	137	405	6.3	
9.29	151	390	6.7	
8.05	174	365	7.2	
7.00	200	345	7.8	
5.00	280	300	9.6	
150.15	9.3	820	0.87	AD2
128.12	11	820	1.0	
112.03	12	820	1.2	
105.19	13	820	1.2	
93.38	15	820	1.4	
79.20	18	820	1.6	
71.50	20	820	1.8	
62.91	22	820	2.1	
59.40	24	820	2.2	
50.58	28	820	2.6	
45.96	30	820	2.8	
39.82	35	800	3.2	
36.93	38	820	3.5	
31.33	45	820	4.2	EK 67 EKA 67 EKF 67 EKAF67
28.28	50	820	4.6	
24.88	56	800	5.1	
23.49	60	780	5.3	
20.00	70	760	6.1	
18.18	77	740	6.5	
15.75	89	700	7.1	
13.71	102	670	7.8	
12.48	112	530	6.8	
10.63	132	500	7.5	
9.66	145	480	7.9	
8.37	167	440	8.4	
7.28	192	420	9.2	
5.20	269	350	10.7	
210.00	6.7	1240	0.94	EK 77 EKA 77 EKF 77 EKAF77
194.25	7.2	1160	0.95	
168.31	8.3	1550	1.5	
147.83	9.5	1550	1.7	
139.13	10	1550	1.8	
124.09	11	1550	2.0	
106.05	13	1550	2.3	
96.25	15	1550	2.6	
85.31	16	1550	2.9	
80.85	17	1550	3.1	
70.76	20	1550	3.5	
63.75	22	1550	3.9	
55.92	25	1550	4.4	
49.35	28	1550	5.0	

传动比 Ratio	输出转速 Output speed	许用扭矩 Permissible torque	额定功率 Nominal Power Ratings	机型号 Type
(i)	[r/min]	[Nm]	[kW]	
33.74	41	1550	7.3	EK 77 EKA 77 EKF 77 EKAF77
31.98	44	1550	7.7	
27.99	50	1550	8.8	
25.22	56	1550	9.8	
22.12	63	1500	10.8	
19.52	72	1450	11.8	
17.30	81	1400	12.9	
14.78	95	1340	14.5	
12.93	108	1000	12.3	
11.34	123	990	13.9	
10.01	140	940	15.0	
8.87	158	890	16.0	
7.58	185	785	16.5	
194.56	7.2	2700	2.2	AD2
171.71	8.2	2700	2.5	
162.00	8.6	2700	2.7	
145.23	9.6	2700	3.0	
125.10	11	2700	3.4	
114.17	12	2700	3.8	
101.25	14	2700	4.2	
85.11	16	2700	5.1	
78.21	18	2700	5.5	
69.46	20	2700	6.2	EK 87 EKA 87 EKF 87 EKAF87
62.10	23	2700	6.9	
55.83	25	2700	7.7	
48.46	29	2700	8.9	
43.39	32	2600	9.5	
36.00	39	2500	11.1	
30.94	45	2700	13.9	
27.47	51	2600	15.1	
24.56	57	2500	16.2	
22.08	63	2300	16.6	
19.17	73	2300	19	
17.16	82	2200	20	
16.00	88	1800	17.9	AD3
14.24	98	2100	24	
12.38	113	2000	26	
11.16	125	1500	21	
10.00	140	1500	24	
8.29	169	1400	27	
7.21	194	1300	29	
185.35	7.6	4300	3.7	
161.31	8.7	4300	4.2	
147.69	9.5	4300	4.6	
130.48	11	4300	5.3	
110.69	13	4300	6.2	
101.92	14	4300	6.7	
91.09	15	4300	7.5	
82.01	17	4300	8.4	
74.26	19	4300	9.2	EK 97 EKA 97 EKF 97 EKAF97
65.85	21	4300	10.4	
59.54	24	4300	11.5	
50.46	28	4300	13.6	
44.08	32	4300	15.5	
40.31	35	4300	17.0	
36.03	39	4300	19	
32.44	43	4300	21	
29.37	48	4300	23	
26.05	54	4300	26	
23.55	59	4300	29	
19.96	70	4300	34	
17.43	80	4300	39	
14.58	96	4300	47	
12.62	111	3890	49	

传动比 Ratio	输出转速 Output speed	许用扭矩 Permissible torque	额定功率 Nominal Power Ratings	机型号 Type
(i)	[r/min]	[Nm]	[kW]	
11.27	124	2870	41	EK 97 EKA 97 EKF 97 EKAF97
9.84	142	2660	43	
8.23	170	2660	51	
7.13	196	2660	59	
149.06	9.4	8000	8.6	
126.20	11	8000	10.1	
116.79	12	8000	10.9	
104.67	13	8000	12.2	
94.50	15	8000	13.5	
85.83	16	8000	14.9	
76.15	18	8000	16.7	
69.11	20	8000	18.4	
59.40	24	8000	21	
51.85	27	7840	24	EK 107 EKA 107 EKF 107 EKAF107
43.98	32	7360	27	
38.44	36	7200	30	
33.95	41	7200	34	
32.50	43	6800	33	
30.12	46	7200	38	
27.33	51	7200	42	
23.49	60	7200	49	AD6
20.51	68	7170	56	
17.39	80	6080	56	
15.20	92	5310	56	
13.68	102	4300	50	
11.94	117	4260	57	
10.13	138	3610	57	
8.85	158	3150	57	
7.49	187	3150	67	
152.25	9.2	13000	13.6	AD4
141.89	9.9	13000	14.6	
127.66	11	13000	16.2	
114.84	12	13000	18.0	AD5
93.69	15	13000	22	
85.45	16	13000	24	
73.95	19	13000	28	
65.25	21	13000	32	
56.35	25	13000	37	
49.84	28	13000	42	
41.89	33	13000	49	
37.77	37	13000	55	
32.69	43	13000	63	
28.84	49	13000	72	
24.91	56	13000	83	
22.03	64	13000	94	
18.52	76	13000	112	
14.96	94	12100	129	
12.78	110	8530	106	
10.74	130	8000	119	
8.68	161	7230	133	
150.41	9.3	18000	19	EK 127 EKA 127 EKF 127 EKAF127
122.39	11	18000	23	
100.22	14	18000	29	
91.65	15	18000	31	
79.75	18	18000	36	
70.38	20	18000	41	
61.02	23	18000	47	
54.29	26	18000	53	
46.06	30	18000	62	EK 157 EKA 157 EKF 157 EKAF157
38.02	37	18000	75	

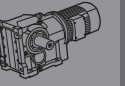
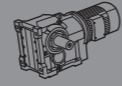

传动比 Ratio	输出转速 Output speed	许用扭矩 Permissible torque	额定功率 Nominal Power Ratings	机型号 Type
(i)	(r/min)	(Nm)	(kW)	
31.30 27.62 23.95 21.31 18.08 14.92 12.66	45 51 58 66 77 94 111	17700 16000 18000 18000 18000 18000 17000	90 92 120 135 159 192 214	EK 157 EKA 157 EKF 157 EKAF157 AD8
164.50 134.99	8.5 10	29500 32000	29 38	AD5
109.83	13	32000	46	AD7
87.86 78.14 68.07 60.74 51.77 42.89 36.61 32.25 28.77 24.52 20.32 17.34	16 18 21 23 27 33 38 43 49 57 69 81	32000 32000 32000 32000 32000 32000 32000 28100 25100 32000 31000 28100	58 65 75 84 98 119 139 139 208 243 258	EK 167 EKA167 AD8
179.86 165.21	7.8 8.5	50000 50000	44 48	AD7
144.59 129.69 112.60 102.16 88.00 73.96 64.04 53.36 45.50 42.51 38.57 33.23 27.92 24.18 20.15 17.18	9.7 11 12 14 16 19 22 26 31 33 36 42 50 58 69 81	50000 50000 50000 50000 50000 50000 50000 50000 50000 40000 40000 46400 43300 39100 32600 32000	55 61 71 78 91 108 124 149 175 150 165 223 247 258 258 297	EK 187 EKA187 AD8

传动比 Ratio	输出转速 Output speed	许用扭矩 Permissible torque	额定功率 Nominal Power Ratings	机型号 Type
(i)	(r/min)	(Nm)	(kW)	

EK37

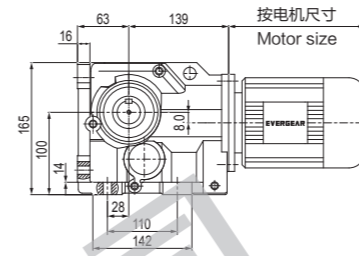

EKAB37

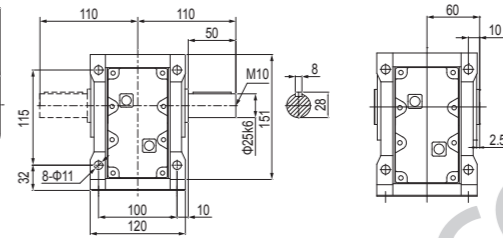

EK..S37

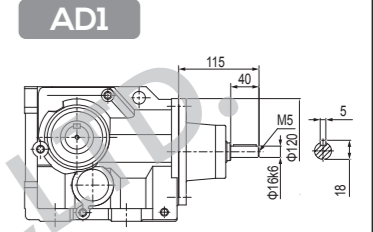

AD2

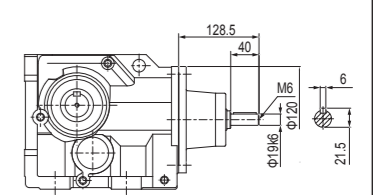

EKF37

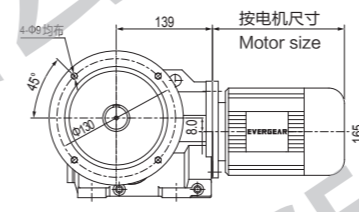

EKAF37

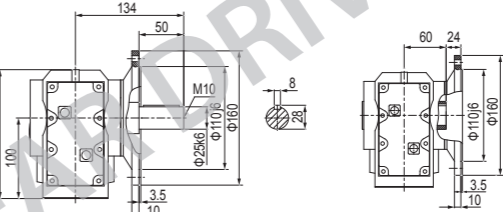

EKA37

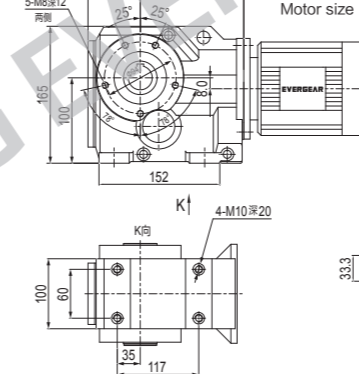

EKAT37

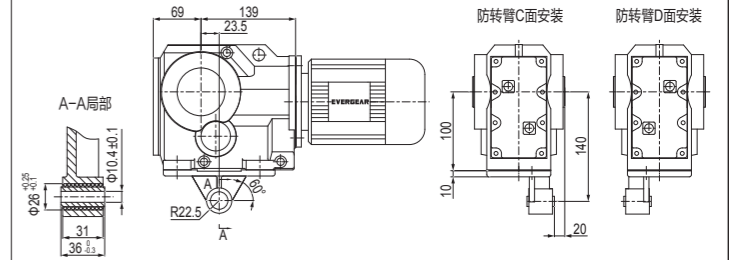

EKAZ37

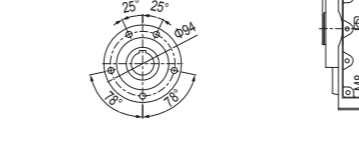

EK..37ER17

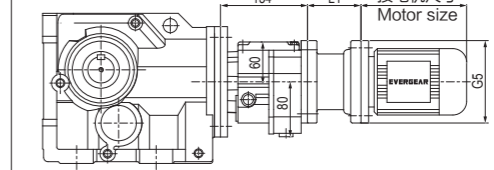

Y2电机座号 Motor size	63
功率4P Power/(kw)	0.12 0.18
L1	75
G5	Φ140

EK..37

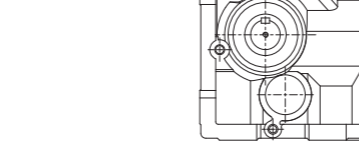

需方自配电机需加联接法兰
Customers provide the motor by themselves need connected flange

Y2电机座号 Motor size	63	71	80	90	100
功率4P Power/(kw)	0.12 0.18	0.25 0.37	0.55 0.75	1.1 1.5	2.2 3
L2	75	75	88.5	88.5	95.5
G5	Φ140	Φ 160	Φ 200	Φ 200	Φ 250

1. EKA, EKF, EKAF, EKAZ壳体为通用件，安装尺寸均可互相参照。
2. "EK.."表示EK系列所有结构形式。
3. 带胀紧盘结构形式，胀紧盘尺寸详见007页。
4. EKA, EKAZ, EKAF, EKAT, EKAB输出轴为通用件，尺寸相同。
5. 需方自配电机G5>Φ200时，是否影响正常安装。

1. The housings of EKA, EKF, EKAF, EKAZ are common parts, The mounting dimensions may consult each other.
2. "EK.." mean all mounting type of EK series.
3. With expansion plate mounting type, see P007 for size details of expansion plate.
4. The output shafts of EKA, EKAZ, EKAF, EKAT, EKAB are common parts, dimensions are the same.
5. If the motor provided by purchaser is G5>Φ200, please check if normal installation is influenced.

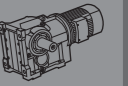
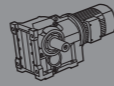

EK47

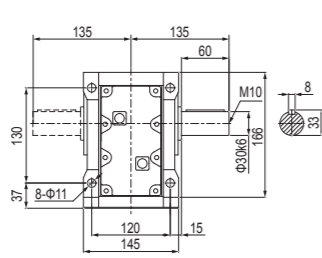
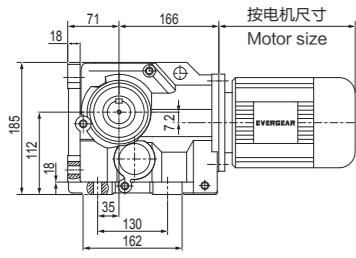

EKAB47

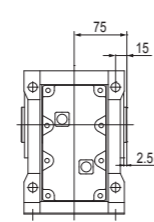

EK..S47

AD2

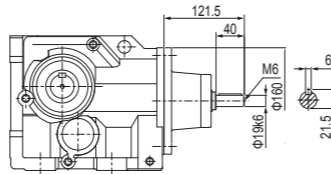

EKF47

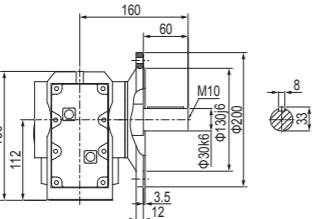
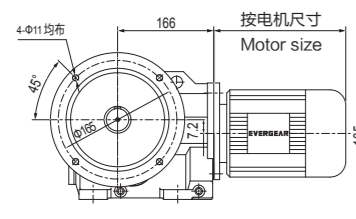

EKAF47

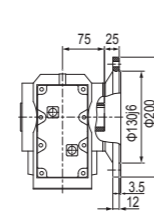

AD3

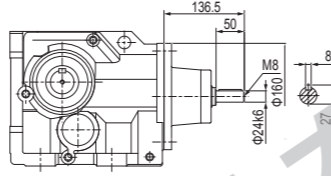

EK57

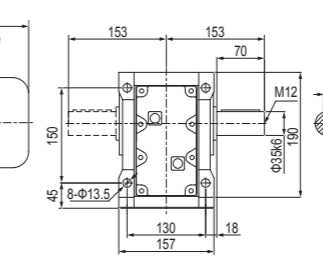
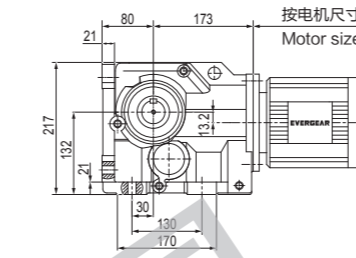

EKAB57

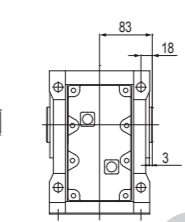

EK..S57

AD2

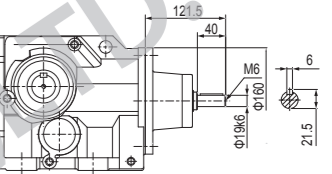

EKA47

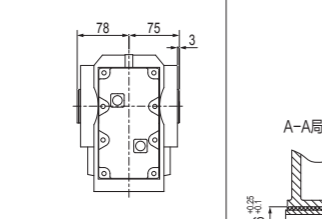
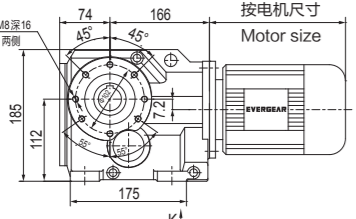

EKAT47

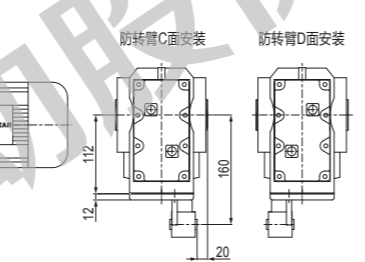
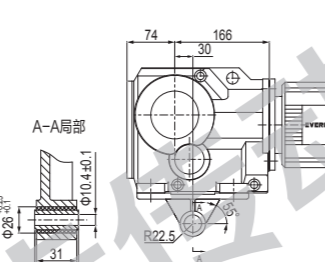

EKAZ47

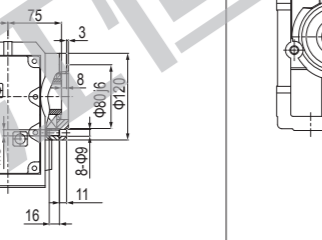
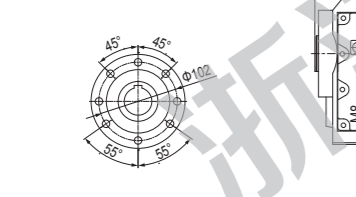

EK..47ER37

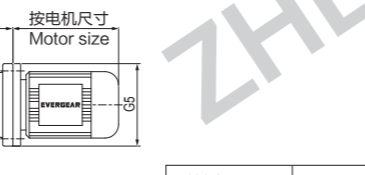
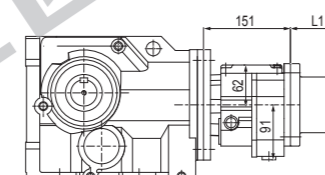

Y2电机型号 Motor size	63
功率4P Power/(kw)	0.12 0.18
L1	75
G5	Φ140

EK..47

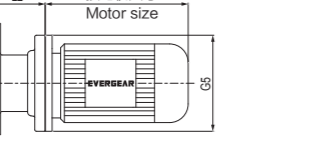
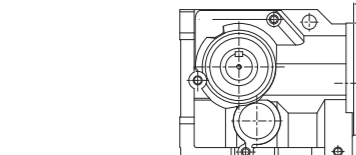

需方自配电机需加联接法兰
Customers provide the motor by themselves need connected flange

Y2电机型号 Motor size	63	71	80	90	100
功率4P Power/(kw)	0.12 0.18	0.25 0.37	0.55 0.75	1.1 1.5	2.2 3
L2	68	68	81.5	81.5	88.5
G5	Φ140	Φ160	Φ200	Φ200	Φ250



1. EKA、EKF、EKAF、EKAZ壳体为通用件，安装尺寸均可互相参照。
2. "EK."表示EK系列所有结构形式。
3. 带膨胀盘结构形式，膨胀盘尺寸详见007页。
4. EKA、EKAZ、EKAF、EKAT、EKAZ输出轴为通用件，尺寸相同。
5. 需方自配电机G5>Φ250时，是否影响正常安装。

1. The housings of EKA、EKF、EKAF、EKAZ are common parts, The mounting dimensions may consult each other.
2. "EK." mean all mounting type of MTJ series.
3. With expansion plate mounting type, see P007 for size details of expansion plate.
4. The output shafts of EKA、EKAZ、EKAF、EKAT、EKAZ are common parts, dimensions are the same.
5. If the motor provided by purchaser is G5>Φ250, please check if normal installation is influenced.

EK..57

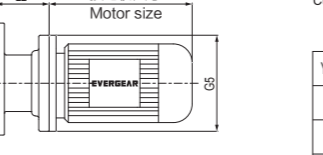
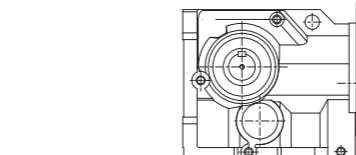

需方自配电机需加联接法兰
Customers provide the motor by themselves need connected flange

Y2电机型号 Motor size	63	71	80	90	100	112
功率4P Power/(kw)	0.12 0.18	0.25 0.37	0.55 0.75	1.1 1.5	2.2 3	4
L2	68	68	81.5	81.5	88.5	88.5
G5	Φ140	Φ160	Φ200	Φ200	Φ250	Φ250



1. EKA、EKF、EKAF、EKAZ壳体为通用件，安装尺寸均可互相参照。
2. "EK."表示EK系列所有结构形式。
3. 带膨胀盘结构形式，膨胀盘尺寸详见007页。
4. EKA、EKAZ、EKAF、EKAT、EKAZ输出轴为通用件，尺寸相同。
5. 需方自配电机G5>Φ250时，是否影响正常安装。

1. The housings of EKA、EKF、EKAF、EKAZ are common parts, The mounting dimensions may consult each other.
2. "EK." mean all mounting type of EK series.
3. With expansion plate mounting type, see P007 for size details of expansion plate.
4. The output shafts of EKA、EKAZ、EKAF、EKAT、EKAZ are common parts, dimensions are the same.
5. If the motor provided by purchaser is G5>Φ250, please check if normal installation is influenced.

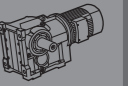
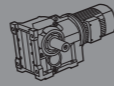

EK67

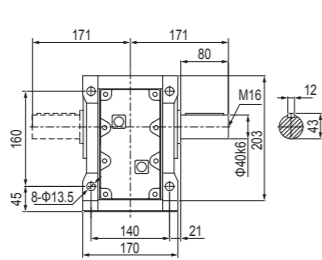
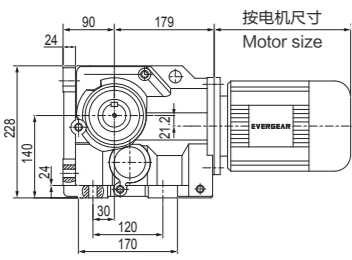

EKAB67

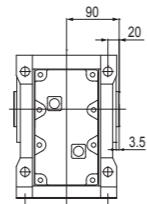

EK..S67

AD2

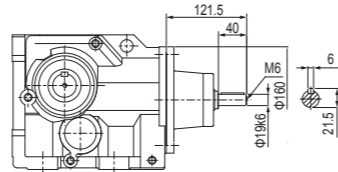

AD3

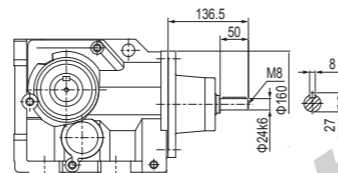

EKF67

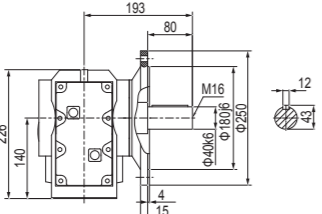
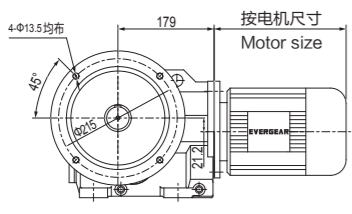

EKAF67

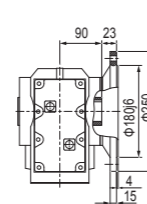

EKA67

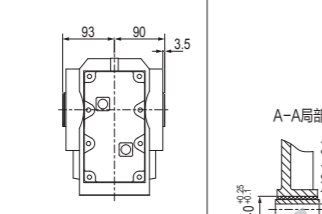
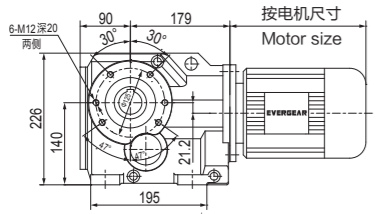

EKAT67

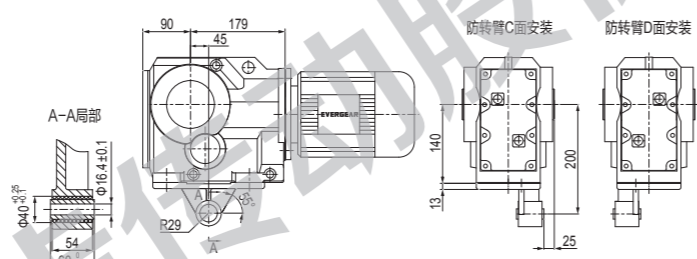

EKAZ67

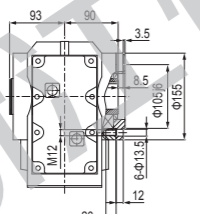
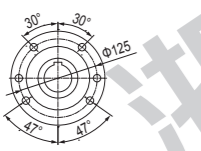

EK..67ER37

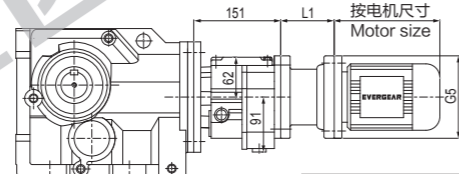

Y2电机型号 Motor size	63	71	80
功率4P Power/(kw)	0.12 0.18	0.25 0.37	0.55
L1	75	75	88.5
G5	Φ140	Φ160	Φ200

EK..67

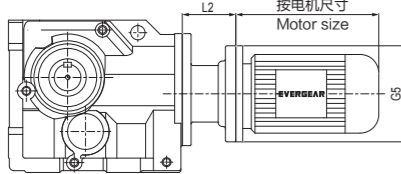

需方自配电机需加联接法兰
Customers provide the motor by themselves need connected flange

Y2电机型号 Motor size	63	71	80	90	100	112	132
功率4P Power/(kw)	0.18 0.25 0.37	0.55 0.75	1.1 1.5	2.2 3	4	5.5	
L2	68	68	81.5	81.5	88.5	88.5	124.5
G5	Φ140	Φ160	Φ200	Φ200	Φ250	Φ250	Φ300



1. EKA, EKF, EKAF, EKAZ壳体为通用件, 安装尺寸均可互相参照。
2. "EK.."表示EK系列所有结构形式。
3. 带胀紧盘结构形式, 胀紧盘尺寸详见007页。
4. EKA, EKAZ, EKAF, EKAT, EKAZ输出轴为通用件, 尺寸相同。
5. 需方自配电机G5>Φ250时, 是否影响正常安装。

1. The housings of EKA, EKF, EKAF, EKAZ are common parts, The mounting dimensions may consult each other.
2. "EK.." mean all mounting type of EK series.
3. With expansion plate mounting type, see P007 for size details of expansion plate.
4. The output shafts of EKA, EKAZ, EKAF, EKAT, EKAZ are common parts, dimensions are the same.
5. If the motor provided by purchaser is G5>Φ250, please check if normal installation is influenced.

EK77

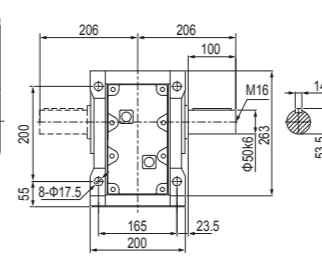
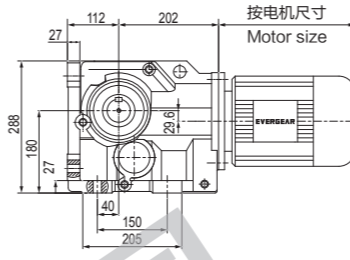

EKAB77

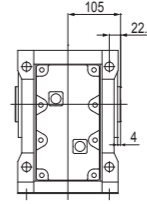

EK..S77

AD2

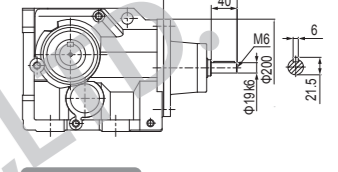

AD3

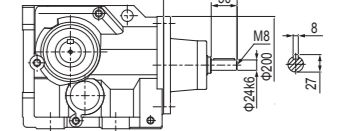

AD4

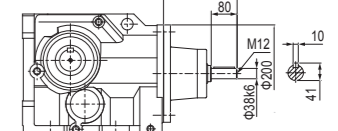

EKF77

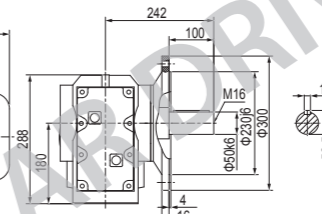
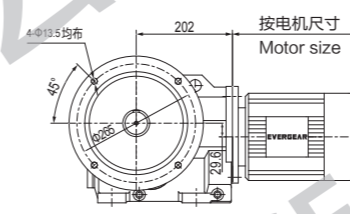

EKAF77

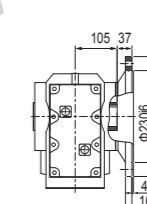

EKA77

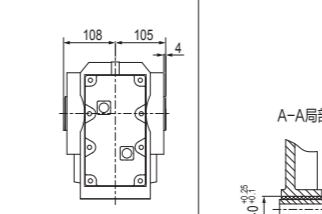
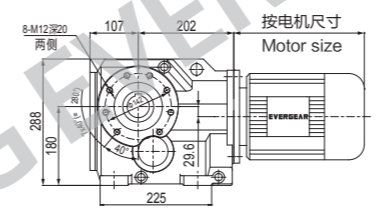

EKAT77

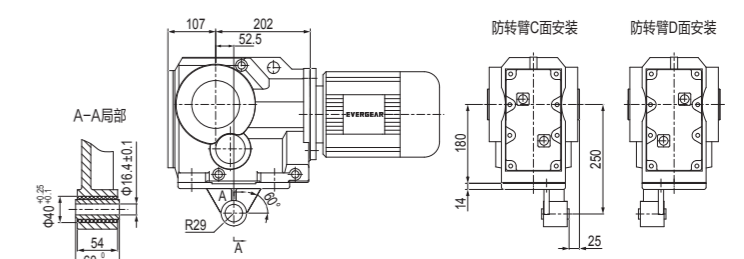

EKAZ77

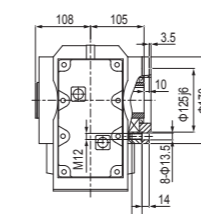
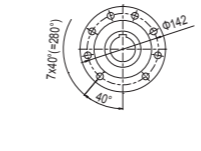

EK..77ER37

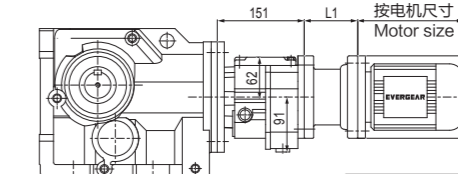

Y2电机型号 Motor size	63	71	80
功率4P Power/(kw)	0.12 0.18	0.25 0.37	0.55 0.75
L1	75	75	88.5
G5	Φ140	Φ160	Φ200

EK..77

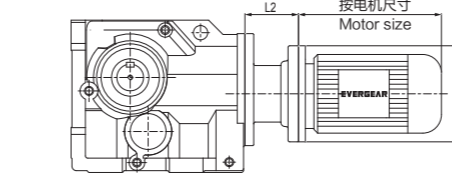

需方自配电机需加联接法兰
Customers provide the motor by themselves need connected flange

Y2电机型号 Motor size	71	80	90	100	112	132	160
功率4P Power/(kw)	0.37 0.55 0.75	1.1 1.5	2.2 3	4	5.5 7.5	11	
L2	60.5	74	74	81	81	117	156
G5	Φ160	Φ200	Φ200	Φ250	Φ250	Φ300	Φ350



1. EKA, EKF, EKAF, EKAZ壳体为通用件, 安装尺寸均可互相参照。
2. "EK.."表示EK系列所有结构形式。
3. 带胀紧盘结构形式, 胀紧盘尺寸详见008页。
4. EKA, EKAZ, EKAF, EKAT, EKAZ输出轴为通用件, 尺寸相同。
5. 需方自配电机G5>Φ300时, 是否影响正常安装。

1. The housings of EKA, EKF, EKAF, EKAZ are common parts, The mounting dimensions may consult each other.
2. "EK.." mean all mounting type of EK series.
3. With expansion plate mounting type, see P008 for size details of expansion plate.
4. The output shafts of EKA, EKAZ, EKAF, EKAT, EKAZ are common parts, dimensions are the same.
5. If the motor provided by purchaser is G5>Φ300, please check if normal installation is influenced.

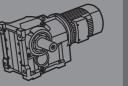
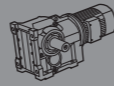

EK87

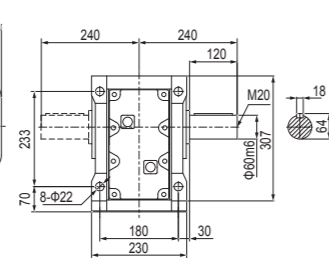
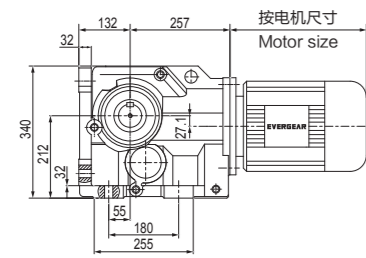

EKAB87

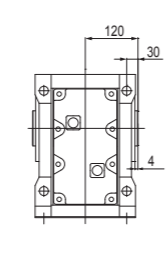

EK..S87

AD2

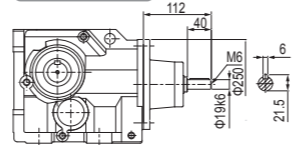

AD3

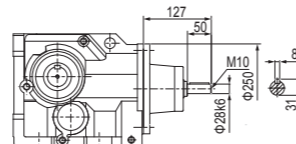

AD4

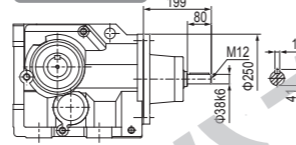

AD5

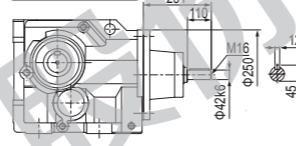

EKF87

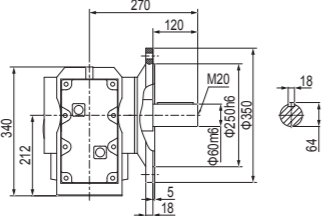
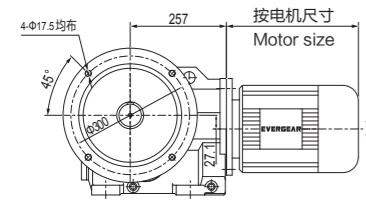

EKAF87

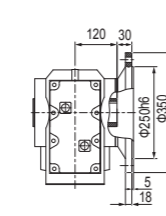

EKA87

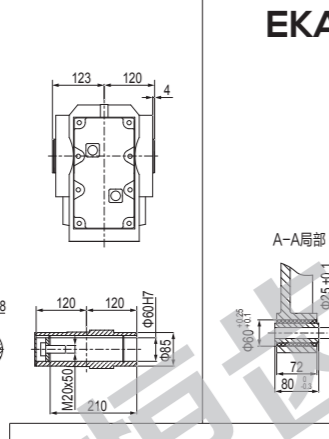
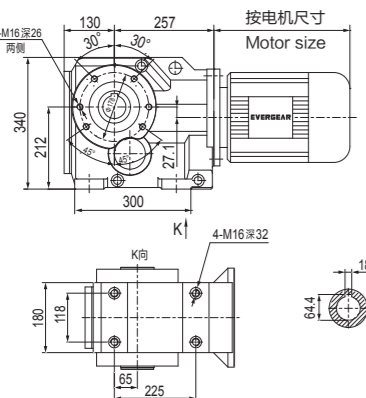

EKAT87

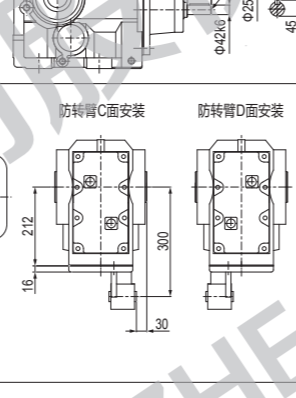
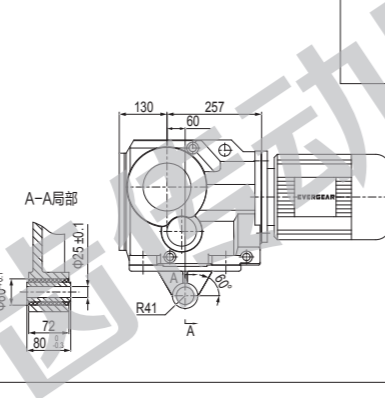

EKAZ87

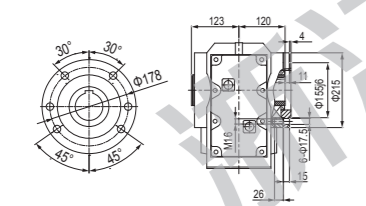

EK..87ER57

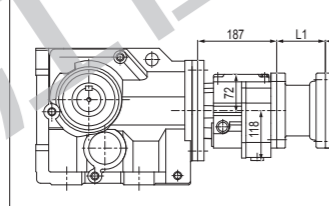

Y2电机型号 Motor size	63	71	80	90				
功率4P Power/(kw)	0.12	0.18	0.25	0.37	0.55	0.75	1.1	1.5
L1	68	68	81.5	81.5				
G5	Φ140	Φ160	Φ200	Φ200				

EK..87

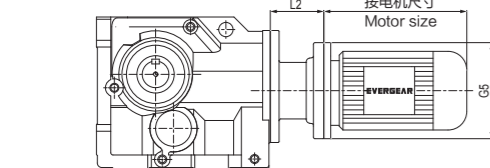

需方自配电机需加联接法兰
Customers provide the motor by themselves need connected flange

Y2电机型号 Motor size	80	90	100	112	132	160	180					
功率4P Power/(kw)	0.75	1.1	1.5	2.2	3	4	5.5	7.5	11	15	18.5	22
L2	72	72	79	79	113	152	152					
G5	Φ200	Φ200	Φ250	Φ250	Φ300	Φ350	Φ350					

1. The housings of EKA, EKF, EKAF, EKAZ are common parts, The mounting dimensions may consult each other.
2. "EK.."表示EK系列所有结构形式。
3. 带膨胀盘结构形式, 膨胀盘尺寸详见008页。
4. EKA, EKAZ, EKAF, EKAT, EKAB输出轴为通用件, 尺寸相同。

EK97

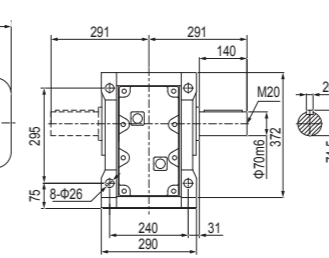
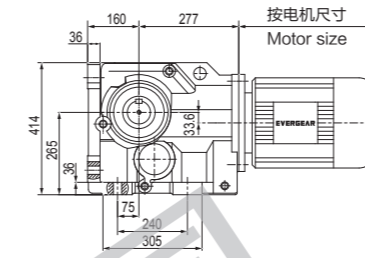

EKAB97

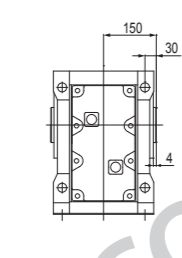

EK..S97

AD3

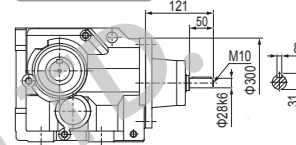

AD4

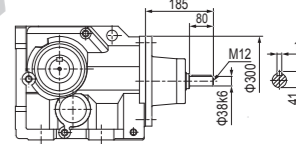

AD5

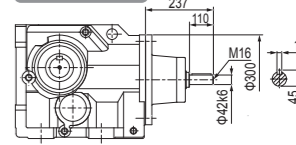

AD6

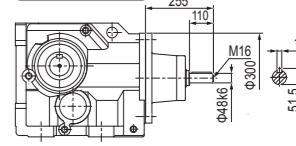

EKF97

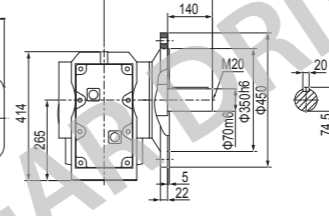
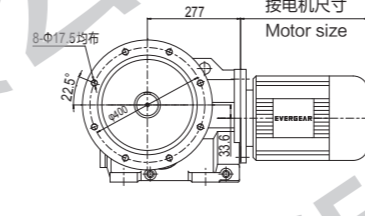

EKAF97

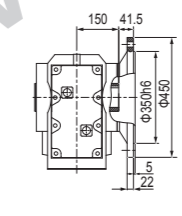

EKA97

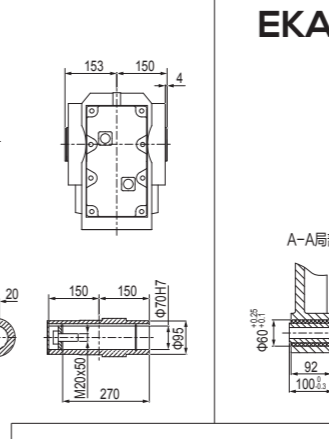
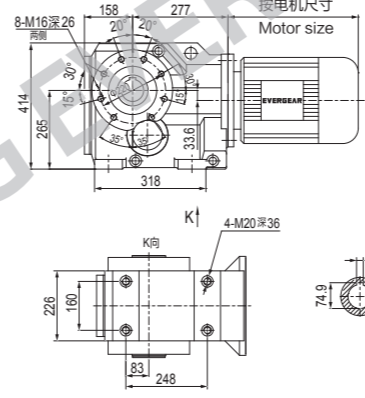

EKAT97

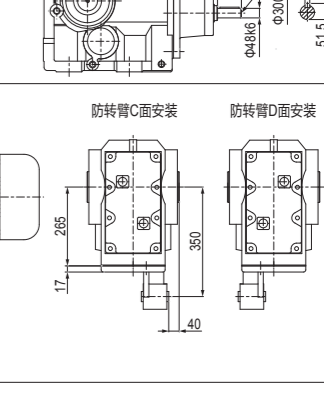
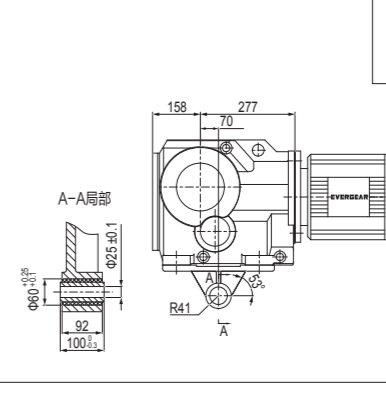

EKAZ97

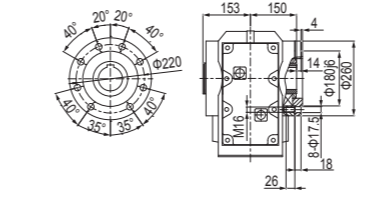

EK..97ER57

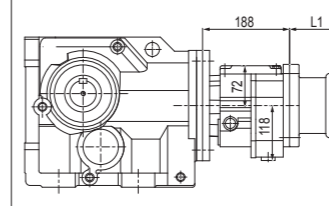

Y2电机型号 Motor size	63	71	80	90	100	112					
功率4P Power/(kw)	0.12	0.18	0.25	0.37	0.55	0.75	1.1	1.5	2.2	3	4
L1	68	68	81.5	81.5	88.5	88.5					
G5	Φ140	Φ160	Φ200	Φ200	Φ250	Φ250					

EK..97

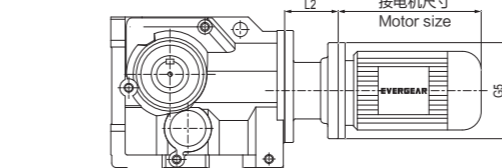

需方自配电机需加联接法兰
Customers provide the motor by themselves need connected flange

Y2电机型号 Motor size	90	100	112	132	160	180	200					
功率4P Power/(kw)	1.1	1.5	2.2	3	4	5.5	7.5	11	15	18.5	22	30
L2	66	73	73	99	138	138	146					
G5	Φ200	Φ250	Φ250	Φ300	Φ350	Φ350	Φ400					

1. The housings of EKA, EKF, EKAF, EKAZ are common parts, The mounting dimensions may consult each other.
2. "EK.."表示EK系列所有结构形式。
3. 带膨胀盘结构形式, 膨胀盘尺寸详见008页。
4. EKA, EKAZ, EKAF, EKAT, EKAB输出轴为通用件, 尺寸相同。

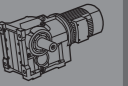
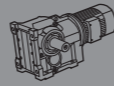

EK107

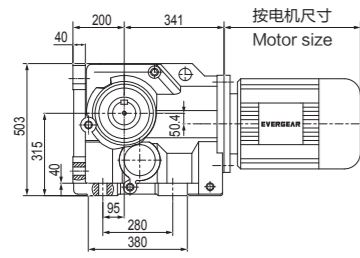

EKAB107

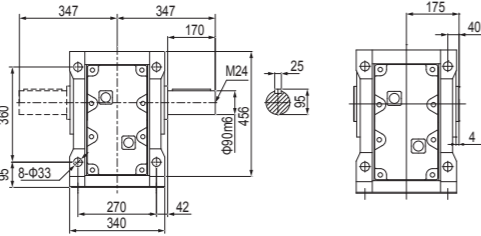

EK..S107

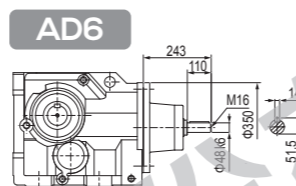
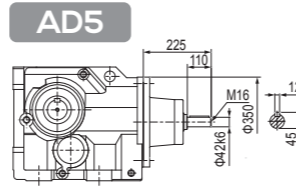
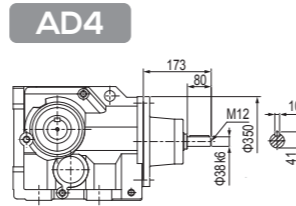

EKF107

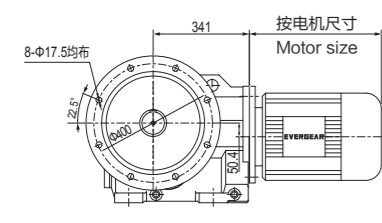

EKAF107

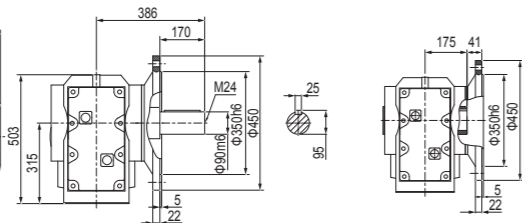

EKA107

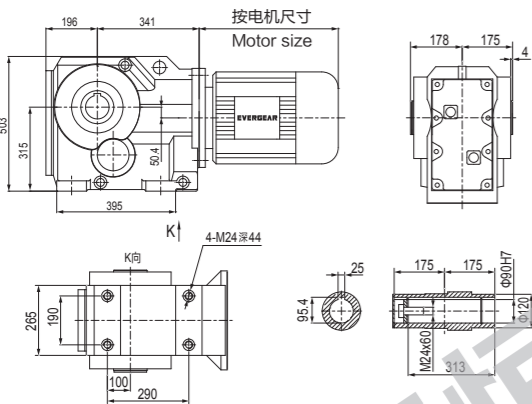

EKAT107

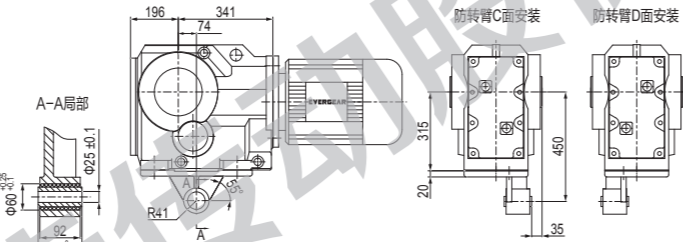

EKAZ107

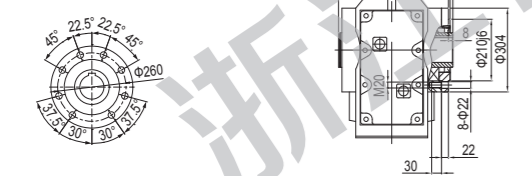

EK..107ER77

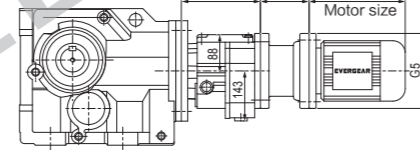

Y2电机座号 motor size	63	71	80	90	100	112	132
功率4P power/(kw)	0.12	0.18	0.25	0.37	0.55	0.75	1.1
L1	60.5	60.5	74	74	81	81	117
G5	Φ140	Φ160	Φ200	Φ200	Φ250	Φ250	Φ300

EK..107

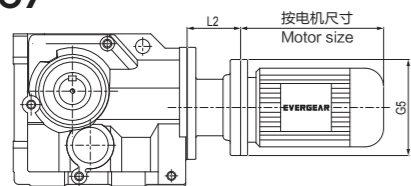

需方自配电机需加联接法兰
Customers provide the motor by themselves need connected flange

Y2电机座号 Motor size	100	112	132	160	180	200	225
功率4P Power/(kw)	3	4	5.5	7.5	11	15	18.5
L2	65	65	87	126	126	134	177
G5	Φ250	Φ250	Φ300	Φ350	Φ350	Φ400	Φ450

1. EKA、EKF、EKAF、EKAZ壳体为通用件，安装尺寸均可互相参照。
2. "EK.."表示EK系列所有结构形式。
3. 带膨胀盘结构形式，膨胀盘尺寸详见008页。
4. EKA、EKAZ、EKAF、EKAT、EKAB输出轴为通用件，尺寸相同。

1. The housings of EKA、EKF、EKAF、EKAZ are common parts, The mounting dimensions may consult each other.
2. "EK.." mean all mounting type of EK series.
3. With expansion plate mounting type, see P008 for size details of expansion plate.
4. The output shafts of EKA、EKAZ、EKAF、EKAT、EKAB are common parts, dimensions are the same.

EK127

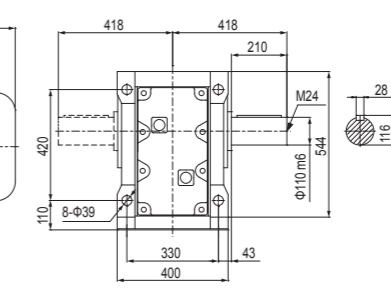
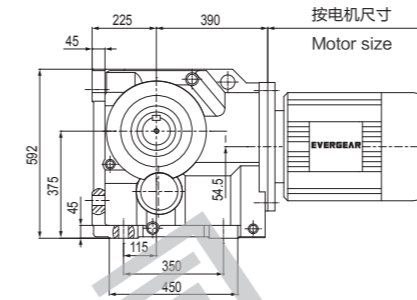

EKF127

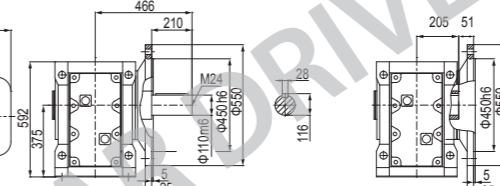
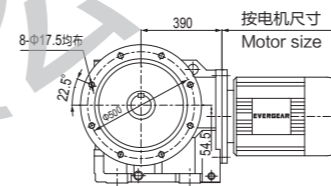

EKA(EKAB)127

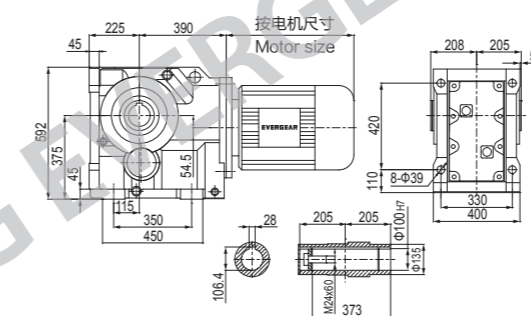

EKAZ127

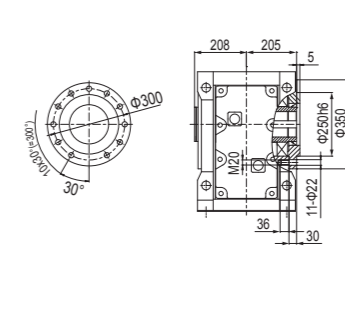

EKAT127

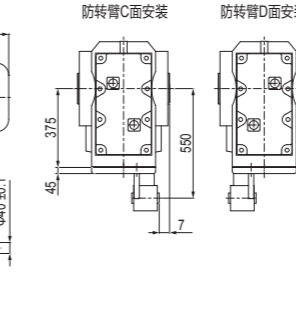
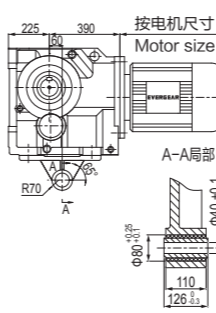

EK..127ER77

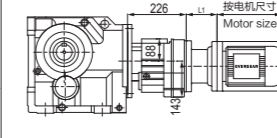

Y2电机座号 motor size	63	71	80	90	100	112
功率4P power/(kw)	0.12	0.18	0.25	0.37	0.55	0.75
L1	60.5	60.5	74	74	81	81
G5	Φ140	Φ160	Φ200	Φ200	Φ250	Φ250

EK..127ER87

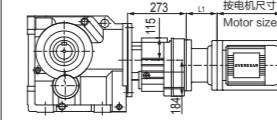

Y2电机座号 motor size	90	100	112	132	160
功率4P power/(kw)	1.5	2.2	3	4	5.5
L1	72	79	79	113	152
G5	Φ200	Φ250	Φ250	Φ300	Φ350

EK..127

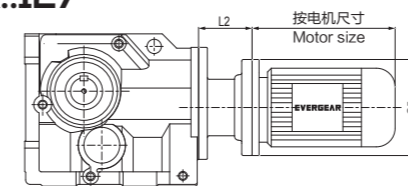

需方自配电机需加联接法兰
Customers provide the motor by themselves need connected flange

Y2电机座号 Motor size	132	160	180	200	225	250	280
功率4P Power/(kw)	7.5	11	15	18.5	22	30	37
L2	77	116	116	124	167	192	192
G5	Φ300	Φ350	Φ350	Φ400	Φ450	Φ550	Φ550

1. 以上壳体壳体为通用件，安装尺寸均可互相参照。
2. "EK.."表示EK系列所有结构形式。
3. 带膨胀盘结构形式，膨胀盘尺寸详见008页。
4. EKA、EKAZ、EKAF、EKAT、EKAB输出轴为通用件，尺寸相同。

1. The housings above are common parts, The mounting dimensions may consult each other.
2. "EK.." mean all mounting type of EK series.
3. With expansion plate mounting type, see P008 for size details of expansion plate.
4. The output shafts of EKA、EKAZ、EKAF、EKAT、EKAB are common parts, dimensions are the same.

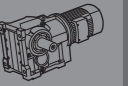
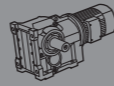

EK157

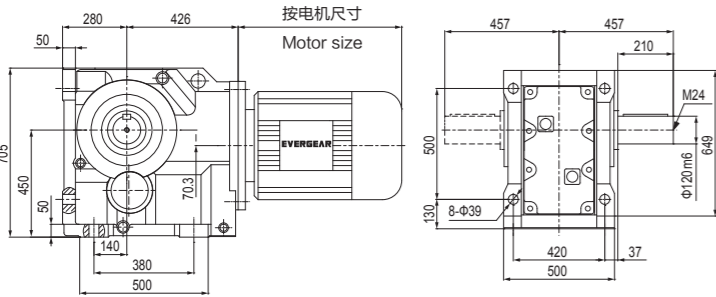

EK..S157

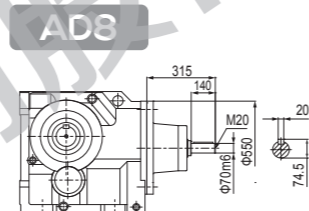
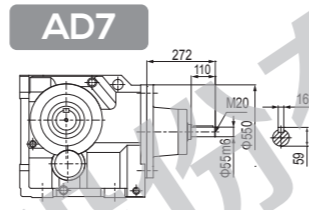
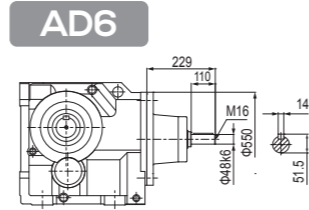
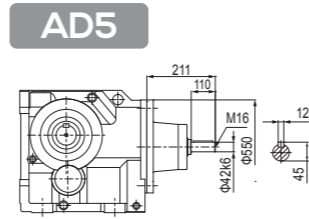

EK167

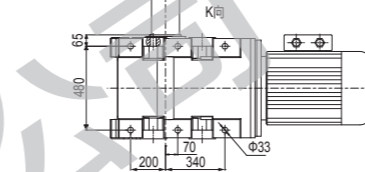
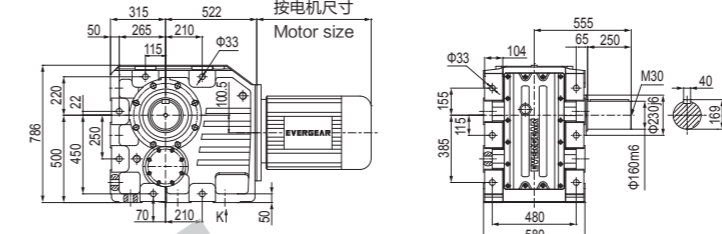

EKA167

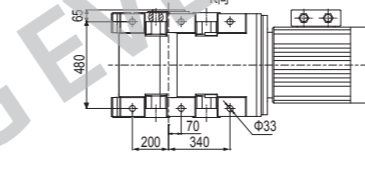
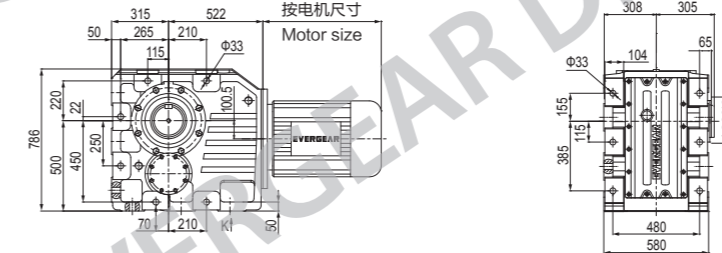

EK..S167

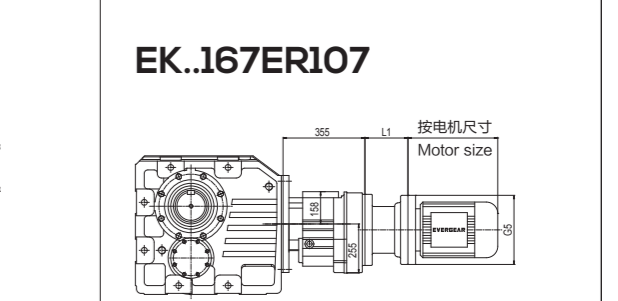
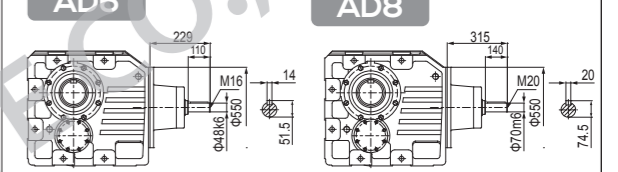
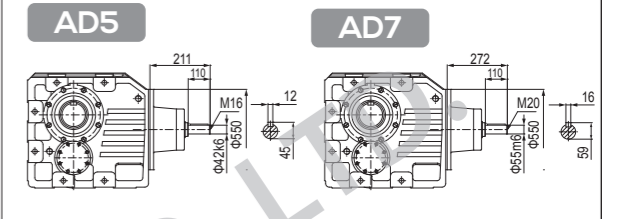

EKF157

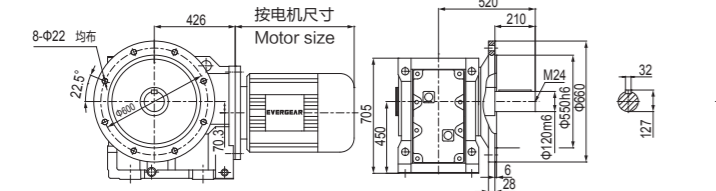

EKAF157

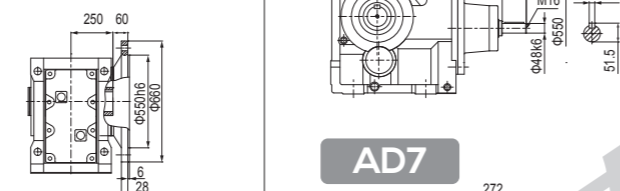

EKA(EKAB)157

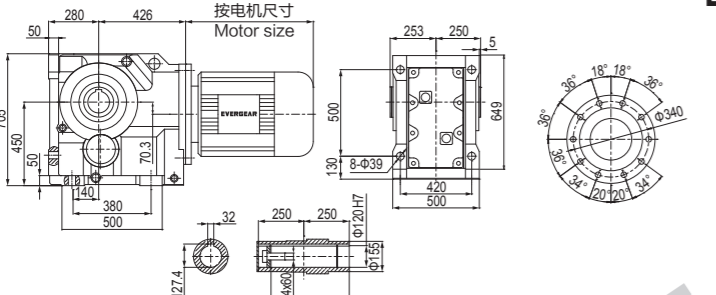

EKAZ157

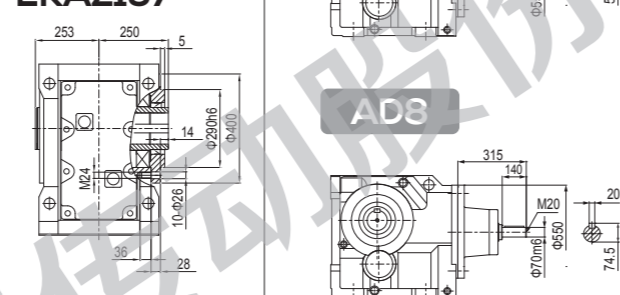

EKAT157

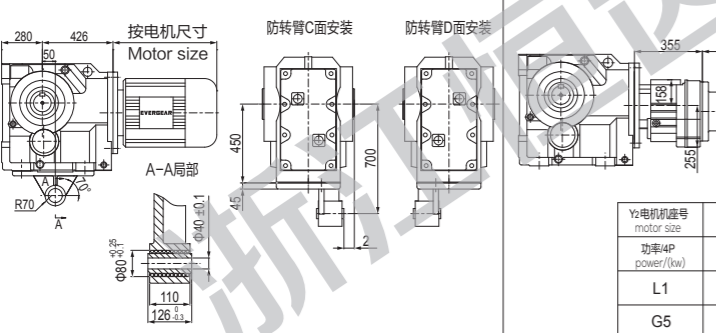

EK..I57ER107

Y2电机座号 motor size	160	180	200	225	250	280	315
功率4P power/(kw)	15	18.5	22	30	37	45	55
L1	126	126	134	144	154	164	174
G5	Φ350	Φ350	Φ400	Φ450	Φ500	Φ550	Φ600

EK..I57ER97

Y2电机座号 motor size	80	90	100	112	132	160
功率4P power/(kw)	0.55	0.75	1.1	1.5	2.2	3
L1	66	66	73	73	99	138
G5	Φ200	Φ200	Φ250	Φ250	Φ300	Φ350

EK..I57

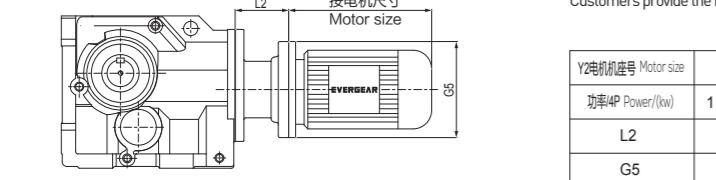

需方自配电机需加联接法兰
Customers provide the motor by themselves need connected flange

Y2电机座号 Motor size	160	180	200	225	250	280	315
功率4P Power/(kw)	11	15	18.5	22	30	37	45
L2	112	112	120	163	183	183	196
G5	Φ350	Φ350	Φ400	Φ450	Φ550	Φ550	Φ660

EKF167

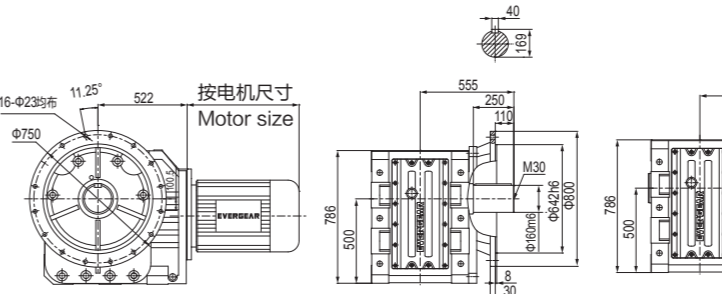

EKAF167

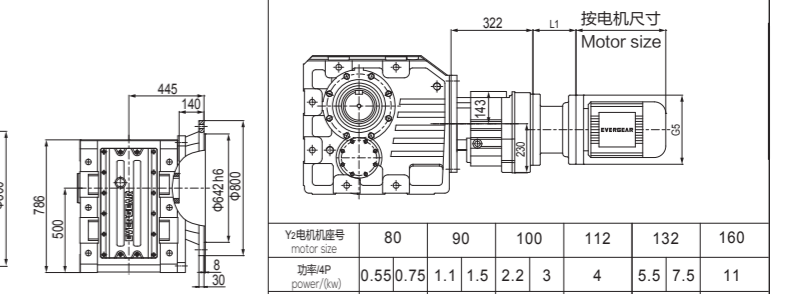

EK..I67

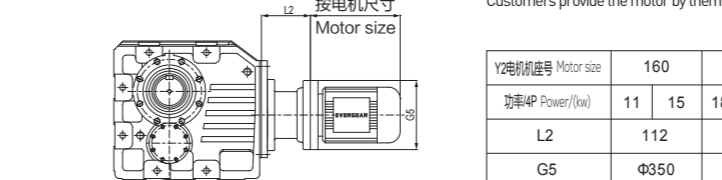

需方自配电机需加联接法兰
Customers provide the motor by themselves need connected flange

Y2电机座号 Motor size	160	180	200	225	250	280	315
功率4P Power/(kw)	11	15	18.5	22	30	37	45
L2	112	112	120	163	183	183	196
G5	Φ350	Φ350	Φ400	Φ450	Φ550	Φ550	Φ660

EK..I67ER107

Y2电机座号 motor size	160	180	200	225
功率4P power/(kw)	11	15	18.5	22
L1	126	126	134	177
G5	Φ350	Φ350	Φ400	Φ450

EK..I67ER97

Y2电机座号 motor size	80	90	100	112	132	160
功率4P power/(kw)	0.55	0.75	1.1	1.5	2.2	3
L1	66	66	73	73	99	138
G5	Φ200	Φ200	Φ250	Φ250	Φ300	Φ350



1.以上壳体壳体为通用件, 安装尺寸均可互相参照。
2."EK.."表示EK系列所有结构形式。
3.带胀紧盘结构形式, 胀紧盘尺寸详见008页。
4.EKA、EKAZ、EKAF、EKAT、EKAB输出轴为通用件, 尺寸相同。

1.The housings above are common parts, The mounting dimensions may consult each other.
2."EK.." mean all mounting type of EK series.
3.With expansion plate mounting type, see P008 for size details of expansion plate.
4.The output shafts of EKA、EKAZ、EKAF、EKAT、EKAB are common parts, dimensions are the same.



1.以上壳体壳体为通用件, 安装尺寸均可互相参照。
2."EK.."表示EK系列所有结构形式。
3.带胀紧盘结构形式, 胀紧盘尺寸详见008页。
4.EKA、EKAF输出轴为通用件, 尺寸相同。

1.The housings above are common parts, The mounting dimensions may consult each other.
2."EK.." mean all mounting type of EK series.
3.With expansion plate mounting type, see P008 for size details of expansion plate.
4.The output shafts of EKA、EKAF are common parts, dimensions are the same.

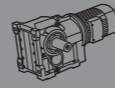

EK187

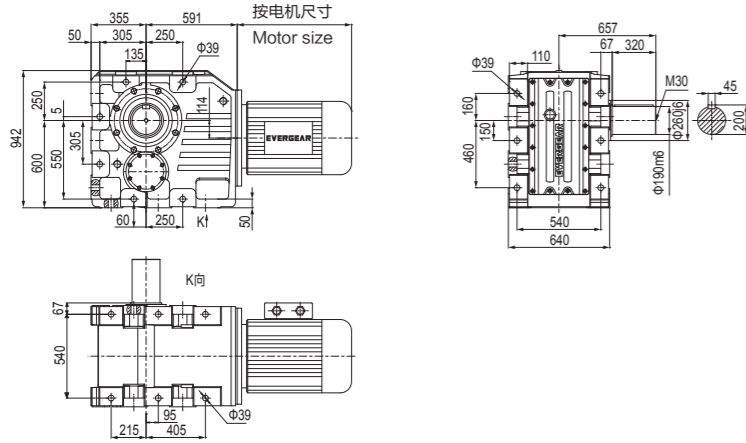

EK..S187

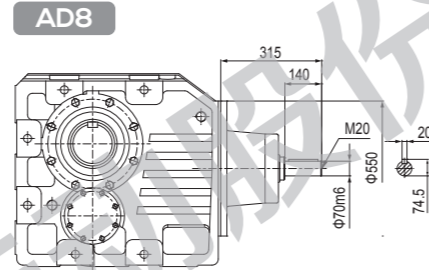
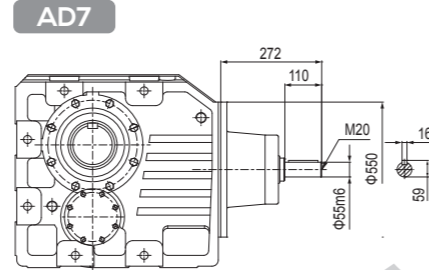
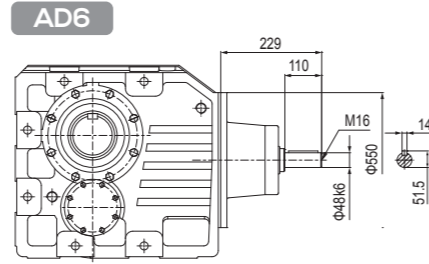

EKA187

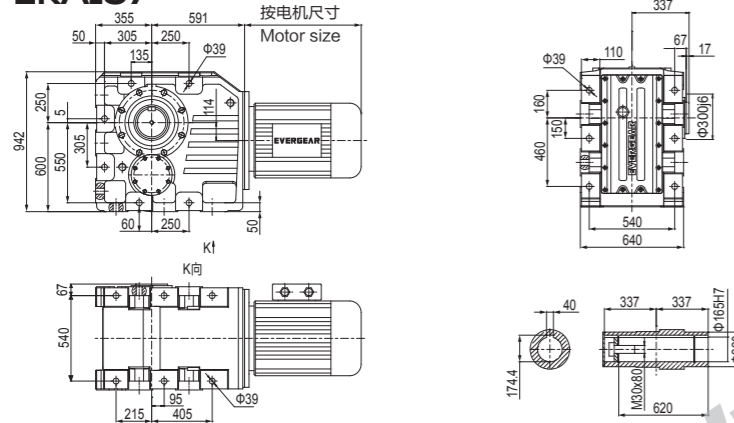

EK..187ER107

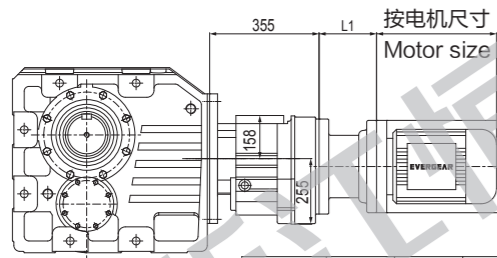

EK..187ER97

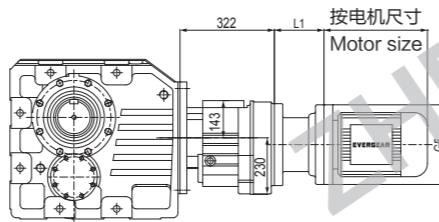

Y2电机座号 motor size	112	132	160	180	200	225	Y2电机座号 motor size	80	90	100	112	132	160							
功率4P power/(kw)	4	7.5	11	15	18.5	22	30	37	45	功率4P power/(kw)	0.55	0.75	1.1	1.5	2.2	3	4	5.5	7.5	11
L1	65	87	126	126	134	177	L1	66	66	73	73	99	138							
G5	Φ250	Φ300	Φ350	Φ350	Φ400	Φ450	G5	Φ200	Φ200	Φ250	Φ250	Φ300	Φ350							

EK..187

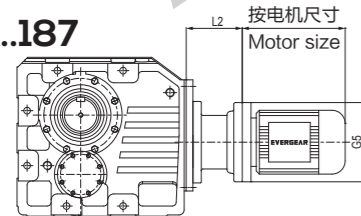

需方自配电机需加联接法兰
Customers provide the motor by themselves need connected flange

Y2电机座号 Motor size	180	200	225	250	280	315						
功率4P Power/(kw)	18.5	22	30	37	45	55	75	90	110	132	160	200
L2	112	120	163	183	183	196						
G5	Φ350	Φ400	Φ450	Φ550	Φ550	Φ660						

1.以上壳体壳体为通用件, 安装尺寸均可互相参照。
2."EK.."表示EK系列所有结构形式。
3.带胀紧盘结构形式, 胀紧盘尺寸详见008页。

1.The housings above are common parts, The mounting dimensions may consult each other.
2."EK.." mean all mounting type of EK series.
3.With expansion plate mounting type, see P008 for size details of expansion plate.

EF Series

平行轴斜齿轮减速机
Parallel Shaft Helical Gear Motor

